

HEAD Units

AUSTRIA
HEAD Austria GmbH
Tyrolliplatz 1
2320 Schwachat
Austria
T. +43 1701 79 0
E. info@at.head.com

CANADA
HEAD Canada Inc
P.O. Box 3620
Station Main
Guelph, Ontario N1H 7H1
Canada
T. +1 519 822 15 76
E. info@ca.head.com

FRANCE
HEAD France
ZA les Condamines
Bresson BP 29
38320 Eybens
France
T. +33 476 62 69 00
E. standard@fr.head.com

GERMANY
HEAD Germany GmbH
Velaskostr. 8
85622 Feldkirchen
Germany
T. +49 89 90 99 95 0
E. info@de.head.com

ITALY
HEAD International
c/o MARES SPA
Sallita Bonsen, 4
San Pietro di Novella
16035 Rapallo (GE)
Italy
T. +39 0185 2011
E. info-head@it.head.com

JAPAN
HTM Sports Japan K.K.
3-27 Kanda-Jimbocho
Chiyoda-ku
Tokyo 101-0051
Japan
T. +81 3 3221 79 21
E. sales100@htm-sports.co.jp

SPAIN
HEAD SPAIN S.L.
Roger 65-67 5a
08028 Barcelona
Spain
T. +34 93 409 20 80
E. info@es.head.com

SWITZERLAND
HEAD Switzerland AG
Ruessenstrasse 16
6342 Baar
Switzerland
T. +41 41 767 07 07
E. info@ch.head.com

UNITED KINGDOM
HEAD UK Ltd
2 Beazon Road
Kendal, Cumbria
LA9 6BW
UK
T. +44 15 39 72 47 40
E. info@uk.head.com

USA
HEAD USA Inc.
Shore Pointe
1 Selleck St.
Norwalk, CT 06855
USA
T. +1 800 874 3235
E. ski@us.head.com

work.head.com

HEAD Trade

HEAD International
HEAD International GmbH
Wuhrkopfweg 1
6921 Kennelbach
Austria
T. +43 55 74 608 0
E. trade@head.com

ARGENTINA
Sports & Adventure S.A.
T. +54 11 6320 3400
E. administracionventas@grupovietes.com

AUSTRALIA
Rosbert International
T. +61 2 952 67 800
E. rosbert@rosbert.com.au

BELARUS
ZAO ELITE SPORTS
T. +375 (29) 6206131
E. tatiana@cast.by

BENELUX
Eurolight BV
T. +31 10 409 1111
E. info@eurolight.nl

BULGARIA
Miras-Krastevi LTD
T. +359 32 640680
E. office@miras-sport.com

CHILE
Inver Tech Ltda
T. +56 2 681 23 08
E. pzunino@invertech.cl

CZECH REPUBLIC
Aspen Sport A.S.
T. +420 2 67 28 1111
E. info@head.cz

CHINA
MAS Ski Equipment Limited
T. +86 (010) 84720338/0339
E. head@masl.biz

CROATIA
Alca Zagreb trgovacko d.o.o
T. +385 1 2481 111
E. ines.kastelan@hr.alcagroup.com

DENMARK
Cool Sport ApS
Claus Ketterle
T. +45 (8853) 7777
E. ck@coolsport.dk

ESTONIA
Balti Autoosad AS
T. +372 6 200 600
E. ragnars@autoparts.ee

FINLAND
Oy Anglo Nordic AB
T. +358 9 4153 5300
E. tapani.vartiainen@anglo.fi

GREECE
Parnass Ski
T. +30 (2670) 22646
E. parnas-ski@otenet.gr

HUNGARY
WINTERSPORT Co. Ltd.
T. +36 1 437 0181
E. toth.etre@tandtsport.hu

ICELAND
Utivera EHF T/A Everest
T. +354 533 44 50
E. everest@everest.is

KAZAKHSTAN
Intelli Sport
T. +7 333 21 777 08
E. intelli.sports@gmail.com

LEBANON
Mike Sport
T. +961 (1) 8888 55
E. mispo@mikesport.com

LITHUANIA
Baltaura
T. +370 5 265 3181
E. baltaura@baltaura.lt

MAZEDONIA
Elteh Dooel Skopje
T. +389 (23) 298 259
E. borce@elteh.com.mk

NEW ZEALAND
M.A. Recreational
T. +64 9 3766 238
E. admin@headnz.co.nz

NORWAY
Gresvig AS
T. +47 23 35 85 00
E. christopher.rogge@gresvig.no

POLAND
Cool Sport
T. +48 501 402 268
E. cool@coolsport.pl

ROMANIA
S.C. Sport Intercom S.R.L.
T. +40 21 224 5419
E. adina@head-sport.ro

RUSSIA
Girvas Sport
T. +7 499 171 44 65
E. m.teplov@girvas.ru

SLOVAKIA
Aspen SK
T. +421 248291522
E. katarina.kollarova@head.sk

SOUTH KOREA
Alchemist
T. +82 31 796 8062
E. alchemist.kr@gmail.com

SWEDEN
Interski AB
T. +46 647 5 06 10
E. micke@interski.se

TURKEY
Sportive Spor
T. +90 212 4817636
E. hakant@toksozspor.com

UKRAINE
SPORT LIDER LTD.
T. +380 50 331 8868
E. viktor@eltrade.com.ua

SNOWBOARDS 2011/12
BOOTS | BINDINGS | SKIS | BINDINGS | BOOTS | ACCESSORIES



HEAD is freezing global warming in partnership with Cool Earth. Join cooearth.org now.



natureOffice.com | DE-141-379073



Paper made from recycled material FSC® C002727

SAP No. 389 001 EN



7 24794 18030 3

THE POWER OF YOU

BIP. BIP. BIP!

At HEAD, we like to stick to what we are good at doing, and one of those things is winning. This past winter, our World Cup Rebels won more crystal and metal in the World Cup and Olympics, than racers from any other brand. If winning equals strength, then Lindsey, Bode, Maria, Didier, and our stable of rebel racers make HEAD strong.

This year, we are thrilled to welcome several exceptional new members to the HEAD World Cup Rebels team, including the amazing Aksel Lund Svindal and Ted "Shred" Ligety. These supreme skiers destroy the competition while having electric personalities. These rebels were born to win.

FASTEN SEATBELTS!
 → ←
 Ladies and gentlemen, please fasten your seatbelts!
 With the gear on the next couple of pages, expect
 nothing less than the fastest ride of your life.

SKIS

RACING/SUPERSHAPE	04
X-SHAPE	06
CHIP	07
ALL MOUNTAIN GROOMER	08
ALL MOUNTAIN FREERIDE	09
BIG MOUNTAIN	10
PARK & PIPE	11
WOMEN	12
JUNIOR	14

BINDINGS

RACING	18
POWERRAIL	19
FREESKI	20
LITERAIL	22
LIGHT DIAGONAL/SUPERLIGHT	23
WOMEN	24
JUNIOR	25

BOOTS

RACING	28
ALL MOUNTAIN PERFORMANCE	30
ALL MOUNTAIN COMFORT	32
FREESKI	34
ALL DAY	35
WOMEN	36
JUNIOR	40

ACCESSORIES

POLES	45
BAGS	48

TECHNOLOGY

KERS	52
FLR	53
HEAD KINEMATICS	54
POWERRAIL	55
LITERAIL	56
RAPTOR	57
ADAPTIVE FIT	58
i-TYPE	59

BOOT TECHNOLOGY:

i-Type Technology

THE FIRST REAL ALL DAY BOOT

Focused on all day comfort on the way to the mountain, on the slope and during après-ski, these boots are a big step for skiers all over the world to feel more secure and comfortable wearing and walking in skiboats.

FEATURES

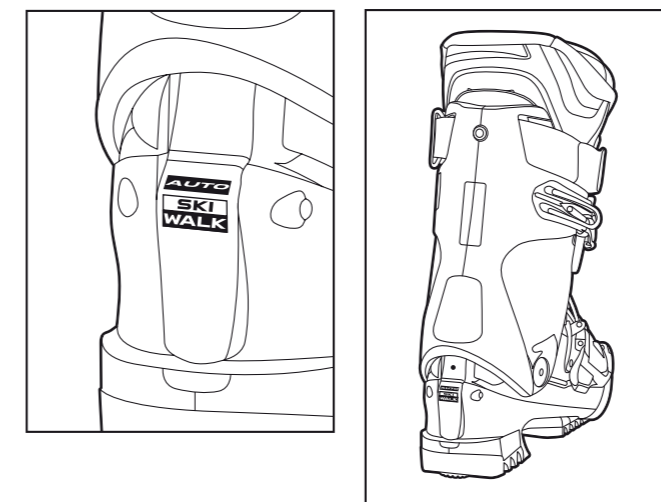
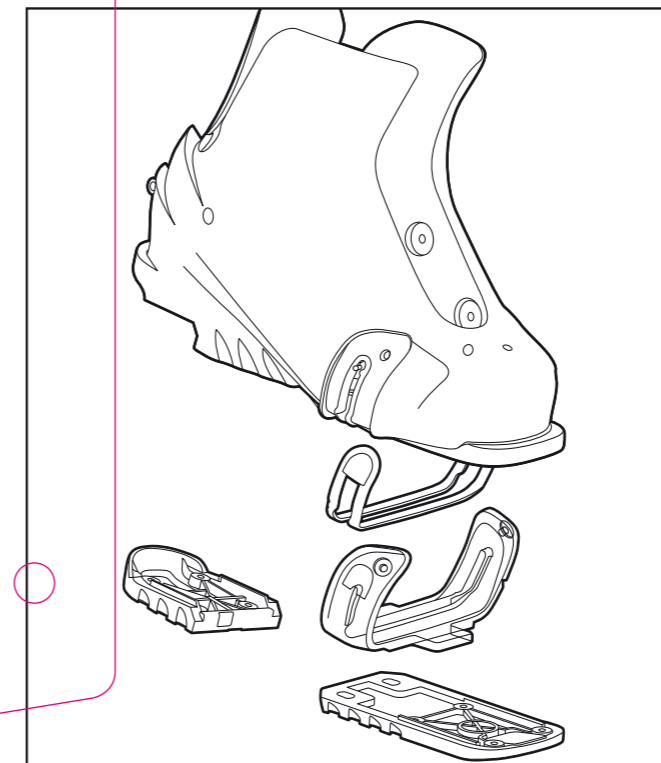

FWS - FLEX WALKING SOLE

The first ski boot with a flexible sole when stepping out of the binding. Patented.

ASW - AUTO SKI WALK

Shaft automatically switches between skiing and walking position when stepping in or out of the binding. Patented.

WIDE BACK DESIGN

Releasing the cuff buckle of the i-Type, the cuff opens backwards generously, allowing for perfect in-store and early morning try-on.

READY TO CLOSE SHELL

Cuff and innerboot tongue are designed to perfectly wrap your foot and automatically close once you step into the boot.

DOUBLE MEMORY BUCKLE

Once you've determined your perfect position, this memory buckle remembers it. Only one move required to close or release the lower shell.

VIBRAM SOLE

i-Type 12 boots feature ISO 5355 Vibram soles on heel and toes. The SoftWalk shock absorption cushioning on the heel makes walking even smoother.

HEAD Skis 2011/2012 are loaded. Loaded with medals, loaded with technology and loaded with attitude. Welcome to the most explosive season in our history.



ELECTROSHOCK THERAPY.

HEAD KERS Technology is the secret sauce that kicks these rapid racers into warpspeed.

The KERS chip releases a jolt of piezoelectric acceleration to make skiers faster out of every turn. We like to think of it as electroshock therapy for speedoholics.



Kinetic Energy Recovery System
KERS

KERS

KERS stands for Kinetic Energy Recovery System: piezoelectric fibers transform kinetic energy into electrical energy which is stored in a chip and released at the end of every turn.

Details > page 52

NOTES:



Worldcup i.SL

art. N°	310041
lengths	155/160/165/170
dimensions	117/66/100 @ length 165
radius	13.0 @ length 165
features	<ul style="list-style-type: none"> • KERS • Intelligence Technology • Race structured UHM C Base • Worldcup Sandwich Construction • Speed Plate +(13)
bindings	HEAD Freeflex Pro 16 (white/black)

Worldcup i.Speed

art. N°	310061
lengths	165/170/175/180/185
dimensions	112/66/94 @ length 180
radius	18.0 @ length 180
features	<ul style="list-style-type: none"> • KERS • Intelligence Technology • Race structured UHM C Base • Worldcup Sandwich Construction • Speed Plate +(13)
bindings	HEAD Freeflex Pro 16 (white/black)

i.Supershape Titan

art. N°	310081
lengths	156/163/170/177
dimensions	128/78/114 @ length 170
radius	13.5 @ length 170
features	<ul style="list-style-type: none"> • KERS • Intelligence Technology • Race structured UHM C Base • Worldcup Sandwich Construction • Speed Plate +(13)
bindings	HEAD Freeflex Pro 14 Wide 88 (white/black)

i.Supershape Magnum

art. N°	310121
lengths	149/156/163/170/177
dimensions	121/71/107 @ length 170
radius	13.5 @ length 170
features	<ul style="list-style-type: none"> • KERS • Intelligence Technology • Race Structured UHM C Base • Worldcup Sandwich Construction • Speed Plate +(13)
bindings	HEAD Freeflex Pro 14 (white/black)

i.Supershape Speed

art. N°	310151
lengths	156/163/170/177/184
dimensions	116/68/100 @ length 170
radius	14.6 @ length 170
features	<ul style="list-style-type: none"> • KERS • Intelligence Technology • Race Structured UHM C Base • Worldcup Sandwich Construction • Speed Plate +(13)
bindings	HEAD Freeflex Pro 14 (white/black)

i.Supershape

art. N°	310171
lengths	155/160/165/170/175
dimensions	121/66/106 @ length 170
radius	12.1 @ length 170
features	<ul style="list-style-type: none"> • KERS • Intelligence Technology • Race Structured UHM C Base • Worldcup Sandwich Construction • Speed Plate +(13)
bindings	HEAD Freeflex Pro 14 (white/black)

art. N°	
lengths	
dimensions	
radius	
features	
bindings	

VROOOOM. THE GOOD TWIN.

For many years, the Porsche 911 has been a car that every driver aspires to take for a lap. Since not every driver can handle - or afford - a 911, Porsche introduced their Cayman model to reach more drivers. If HEAD Supershape skis are our 911, then the new X-Shape series is our Cayman. HEAD is proud to offer these new skis which deliver a taste of the legendary Supershape performance.

NOTES:



X-Shape MTX

art. N°	310201
lengths	149/156/163/170/177
dimensions	125/72/109 @ length 170
radius	12.9 @ length 170
features	<ul style="list-style-type: none"> • Intelligence Technology • Sandwich Construction • Structured UHM C Base • PowerRail
bindings	HEAD PR 11 (white/black)

X-Shape STX

art. N°	310211
lengths	149/156/163/170/177
dimensions	124/68/108 @ length 170
radius	12.1 @ length 170
features	<ul style="list-style-type: none"> • Intelligence Technology • Sandwich Construction • Structured UHM C Base • PowerRail
bindings	HEAD PR 11 (black glossy/silver)



CHIP 71

art. N°	310301
lengths	156/163/170/177
dimensions	121/71/107 @ length 170
radius	13.5 @ length 170
features	<ul style="list-style-type: none"> • Intelligence Chip Technology • Worldcup Sandwich Construction • Race structured UHM C Base • Structured Surface • PowerRail Pro
bindings	HEAD PRD 14 (matt black/chrome)

CHIP 66

art. N°	310321
lengths	152/158/164/170/176
dimensions	118/66/102 @ length 170
radius	13.4 @ length 170
features	<ul style="list-style-type: none"> • Intelligence Chip Technology • Worldcup Sandwich Construction • Race structured UHM C Base • Structured Surface • PowerRail Pro
bindings	HEAD PRD 14 (matt black/chrome)

HIGH-SPEED COMPUTING.

HEAD Intelligence Chip Technology is easy to sum up: it takes the vibrations from your ski, and turns each one onto its head to cancel out new vibrations as they emerge. The faster you ride, the more stable the ski becomes. Now, who's better than you? We can all use a little more Intelligence, and this kind will work on hardpack and beyond.

INTELLIGENCE

Head over to > work.head.com and discover the brains behind Intelligence.



STAY EDGY.

All Mountain Performance doesn't mean all-mountain compromise. It means go anywhere, and ski anything. So, stay edgy: the TT in the names of the HEAD Icon series stands for Torque Turning Technology - and that makes fast, agile, and easy to handle skis with Iconic performance.

TORQUE
TURNING TECHNOLOGY

On > work.head.com we explain in detail how we combine the silkiest ride with the most powerful edge.

NOTES:



Icon TT 800

art. N°	311051
lengths	152/158/164/170/176
dimensions	118/66/102 @ length 170
radius	13.4 @ length 170
features	<ul style="list-style-type: none"> • Intelligence Technology • Torque Turning Technology • Tailwings • Sandwich Construction • Race Structured UHM C Base • PowerRail Pro
bindings	HEAD PRD 12 (white/black)

Icon TT 500

art. N°	311101
lengths	146/152/158/164/170/176
dimensions	116/67/100 @ length 170
radius	14.0 @ length 170
features	<ul style="list-style-type: none"> • Intelligence Technology • Torque Turning Technology • Tailwings • Race Structured UHM C Base • Power Carbon Jacket • PowerRail
bindings	HEAD PR 11 (black glossy/silver)

Icon TT 300

art. N°	311121
lengths	149/156/163/170/177
dimensions	114/68/98 @ length 170
radius	15.3 @ length 170
features	<ul style="list-style-type: none"> • Intelligence Technology • Torque Turning Technology • Tailwings • UHM C Base • Power Fiber Jacket • PowerRail
bindings	HEAD PR 11 (white/black)



VERSATILITY AT ITS PEAK

"Fantastic!" is what we've been hearing about our greatly improved 2011 Peak collection. We kept the name but threw out the moulds (literally, check out the new Peak 90 and 84) to make our best all mountain collection to date. The skis feature graphics designed by renowned Montana graphic artist Pete Thomas, who's legendary style shines through. Not only do these skis look great, but they ski even better. The entire collection features Flow Ride, which gives skiers "rocker when you want it, and stability when you need it." Simply put, these skis are fun, fun, fun for everyone.



Peak features Flow Ride: Rocker when you want it, and stability when you need it. **Details > page 53**

i.Peak 90

art. N°	310411
lengths	163/170/177/184
dimensions	132/89/115 @ length 170
radius	16.1 @ length 170
features	<ul style="list-style-type: none"> • FLR Flow Ride Technology • Intelligence Technology • Sandwich Construction • Structured UHM C Base
bindings	HEAD LX 12 Wide 88 (matt black/white)

i.Peak 84

art. N°	310431
lengths	163/170/177/184
dimensions	128/84/112 @ length 170
radius	15.4 @ length 170
features	<ul style="list-style-type: none"> • FLR Flow Ride Technology • Intelligence Technology • Sandwich Construction • Structured UHM C Base • PowerRail Pro • Also available without PowerRail (Art. 310421)
bindings	HEAD PRD 12 Wide 88 (white/black)

i.Peak 78

art. N°	310451
lengths	159/165/171/177/183
dimensions	124/78/110 @ length 171
radius	14.6 @ length 171
features	<ul style="list-style-type: none"> • FLR Flow Ride Technology • Intelligence Technology • Sandwich Construction • Structured UHM C Base • PowerRail Pro • Also available without PowerRail (Art. 310461)
bindings	HEAD PRD 12 (white/black)

i.Peak 74

art. N°	310601
lengths	149/156/163/170/177
dimensions	121/74/107 @ length 170
radius	14.1 @ length 170
features	<ul style="list-style-type: none"> • FLR Flow Ride Technology • Intelligence Technology • Carbon Jacket • Structured UHM C Base • PowerRail
bindings	HEAD PR 11 (black glossy/silver)

THE ULTIMATE AIR GUITAR.

Big Mountain Skis. Ski big mountains. HEAD skis motor. Motörhead SKIS!

We are proudly dedicating this season's Rocker edition to the band that put the fast rock n' roll on the map: Motörhead. These skis were made to rock backstage... err, the backcountry and with the amount of people out there built for speed, you better make sure to stock up on these axes.

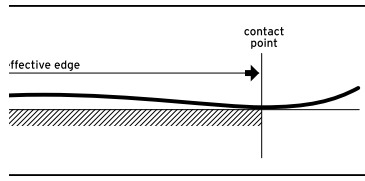

FLR TECHNOLOGY

These skis feature Flow Rise and Flow Rocker, an off-piste dream combo we would never want to see go solo.

Details > page 53

BE VOLATILE.

Speed isn't just for racers. Freeskiers are speedoholics too (and we're not even talking about Jon Olsson who's started showing the Swedish alpine GS team how it's done). The fact is, you can't win a big air contest without a fast inrun, and in the pipe you need lightening-fast skis to keep your airs big and tight. That's where HEAD park and pipe skis come in - Jon designs them to go big and fast, just how you need them.



NOTES:

Boneshaker 125

art. N°	311321
lengths	191
dimensions	146/125/135 @ length 191
radius	32.3 @ length 191
features	<ul style="list-style-type: none"> • FLR Flow Rocker Technology • Sandwich Twintip Construction • Extra Durable ABS Sidewalls • Highly Transparent UHM Base
bindings	HEAD Mojo 18 X (matt black/silver) Attention: Brakes need to be ordered separately

Kiss Of Death 110

art. N°	311301
lengths	171/181/191
dimensions	130/110/120 @ length 181
radius	32.0 @ length 181
features	<ul style="list-style-type: none"> • FLR Flow Rise Technology • Sandwich Twintip Construction • Extra Durable ABS Sidewalls • Highly Transparent UHM Base
bindings	HEAD Mojo 15 (matt black/silver) Attention: Brakes need to be ordered separately

Inferno 104

art. N°	311341
lengths	171/181/191
dimensions	130/104/120 @ length 181
radius	26.0 @ length 181
features	<ul style="list-style-type: none"> • FLR Flow Rise Technology • Sandwich Twintip Construction • Extra Durable ABS Sidewalls • Highly Transparent UHM Base
bindings	HEAD Mojo 15 (matt black/silver) Attention: Brakes need to be ordered separately

Rock'n Roll 94

art. N°	311361
lengths	152/159/166/173/180/187
dimensions	132/94/119 @ length 180
radius	19.5 @ length 180
features	<ul style="list-style-type: none"> • FLR Flow Rise Technology • Sandwich Twintip Construction • Extra Durable ABS Sidewalls • Highly Transparent UHM Base
bindings	HEAD Mojo 15 Wide 97 (matt black/silver)

J.O. Pro

art. N°	311421
lengths	161/171/176/181
dimensions	121/84/110 @ length 181
radius	20.2 @ length 181
features	<ul style="list-style-type: none"> • Sandwich Twintip Construction • Extra Durable ABS Sidewalls • Highly Transparent UHM Base
bindings	HEAD Mojo 15 (matt black/silver) Attention: Brakes need to be ordered separately

GP 84

art. N°	311401
lengths	171/176/181
dimensions	121/84/110 @ length 181
radius	20.2 @ length 181
features	<ul style="list-style-type: none"> • Sandwich Twintip Construction • Extra Durable ABS Sidewalls • Highly Transparent UHM Base
bindings	HEAD Mojo 12 Wide 88 (multicolor)

SBC 79

art. N°	311441
lengths	154/163/172/181
dimensions	112/79/106 @ length 172
radius	19.1 @ length 172
features	<ul style="list-style-type: none"> • Heavy-Duty Construction • Woodcore Twintip Construction • UHM C Base
bindings	HEAD Mojo 12 Wide 88 (multicolor)



CV 81

art. N°	314051
lengths	131/141/151/161
dimensions	116/81/106 @ length 141
radius	11.8 @ length 141
features	<ul style="list-style-type: none"> • Sandwich Twintip Construction • Extra Durable ABS Sidewalls • Highly Transparent UHM Base • Structured Surface
bindings	HEAD Mojo 11 Wide 88 (multicolor)

OM 74

art. N°	314081
lengths	133/142/151/160
dimensions	109/74/98 @ length 142
radius	12.5 @ length 142
features	<ul style="list-style-type: none"> • AIRCOAT Hollow Glass Technology • Highly Transparent UHM Base • Structured Surface
bindings	HEAD Mojo 7.5 Wide 90 (multicolor)

Mojo Jr

art. N°	314401
lengths	87/97/107/117/127/137
dimensions	104/68/92 @ length 127
radius	9.4 @ length 127
features	<ul style="list-style-type: none"> • Real Twintip Construction • E Base Black • Structured Surface
bindings	HEAD SL 45 (white/silver)

In life, it's important to have both feet on the ground. Skiing, you want to keep them planted on the ski. The next generation of HEAD bindings does an even better job at providing stability, security and precision - on the groomed and off the scales.



FLEX ATTACK.

Svindal, Miller, and Vonn are equipped with HEAD, the fastest skis on earth, so we had to make sure their bindings would match the ride. At 100+ kph, there is no time to contemplate your equipment. That's why only the best will work. That's why we re-invented the kinematics of our toes and introduce the improved LX toes this season. Details > page 54

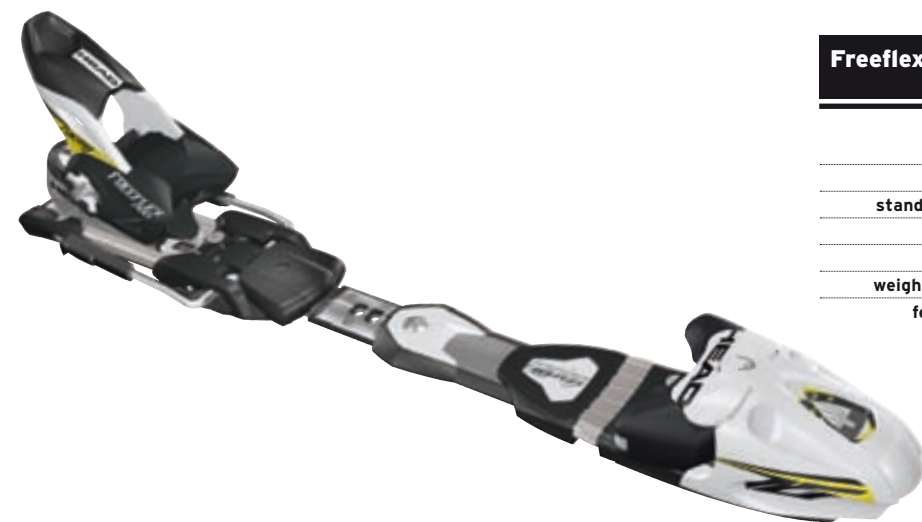

Freeflex Pro 16

art. N°	100305 100306*
color	white/black
stand height	19 mm
DIN	5-16
weight	2680 g
weight range	from 49 kg / 109 lbs
features	<ul style="list-style-type: none"> • AERO Toe with TRP System • Race Diagonal • ABS - Anti Blocking System • Freeflex Pro • Race Pro Heel • Dura-Coating • * Wide Brake 88 mm



Freeflex Pro 14

art. N°	100357 100358*
color	white/black
stand height	21 mm
DIN	4-14
weight	2340 g
weight range	from 42 kg / 92 lbs
features	<ul style="list-style-type: none"> • LX Toe with TRP System • Full Diagonal • ABS - Anti Blocking System • Freeflex Pro • LD Heel • Dura-Coating • * Wide Brake 88 mm



Freeflex Pro 11

art. N°	100360 100359*
color	white/black
stand height	21 mm
DIN	3-11
weight	2250 g
weight range	from 31 kg / 67 lbs
features	<ul style="list-style-type: none"> • LX Toe with TRP System • Full Diagonal • ABS - Anti Blocking System • Freeflex Pro • Race Lite Heel • Dura-Coating • * Wide Brake 88 mm

POWERRAIL

Experience the power on snow and read about it on paper. Details > page 55

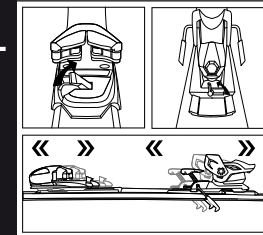

SLICK AND SOLID.

HEAD PowerRail bindings are our most versatile bindings to date. They combine maximum flexibility with perfect power transmission while being the most convenient for handling retail, demo, or rental.



PRD 14

art. N°	100377
color	matt black/chrome
stand height	33.5 mm
DIN	4-14
weight	2210 g
weight range	from 42 kg / 92 lbs
features	<ul style="list-style-type: none"> • AERO Toe with TRP System • Race Diagonal • ABS - Anti Blocking System • PowerRail • LD Heel • Dura-Coating



PRD 12

art. N°	100378 100379*
color	white/black
stand height	33.5 mm
DIN	3.5-12
weight	2080 g
weight range	from 36 kg / 79 lbs
features	<ul style="list-style-type: none"> • LX Toe with TRP System • Full Diagonal • ABS - Anti Blocking System • PowerRail • LD Heel • Dura-Coating • * Wide Brake 88 mm



PR 11

art. N°	100383 100384	colors	black glossy/silver white/black
stand height	31 mm		
DIN	3-11		
weight	1760 g		
weight range	from 31 kg / 67 lbs		
features	<ul style="list-style-type: none"> • SX Toe with TRP System • Full Diagonal • AFS - Anti Friction Slider • PowerRail • SX Heel • Dura-Coating 		

ADJUST AND GO.

If HEAD sold food, then these perfectly lightweight bindings would be our drive through meal: fast, convenient and reliable. Add in great looks and you've got a value meal - get 'em while they're hot!



LR 7.5

art. N°	100335	colors	white/black
	100387		multicolor
stand height	28 mm		
DIN	2-7.5		
weight	1520 g		
weight range	22-84 kg / 48-187 lbs		
features	<ul style="list-style-type: none"> • SL Lite Toe with TRP System • Full Diagonal • ABS - Anti Blocking System • LiteRail • SL Lite Heel • Dura-Coating 		



LR 4.5

art. N°	100338	colors	multicolor
	100339		white/black
stand height	28 mm		
DIN	0.75-4.5		
weight	1330 g		
weight range	10-48 kg / 22-105 lbs		
features	<ul style="list-style-type: none"> • SL Kid Toe with TRP System • Full Diagonal • LiteRail • SL Kid Heel • Dura-Coating 		

LEGENDARY LIGHTNESS.

A new design and improved function give skiers a new level of dynamic power transmission. This season, discover all the advantages of the new HEAD/TYROLIA LX and SX line. Hold on for Generation **NeXt!**
Details > page 54



LX 12 WIDE 88

art. N°	100388		
color	matt black/white		
stand height	21 mm		
DIN	3.5-12		
weight	2010 g		
weight range	from 36 kg / 79 lbs		
features	<ul style="list-style-type: none"> • LX Toe with TRP System • Full Diagonal • ABS - Anti Blocking System • LD Heel • Dura-Coating • Wide Brake 88 mm 		



SX 10

art. N°	100389		
color	silver/black		
stand height	21 mm		
DIN	3-10		
weight	1620 g		
weight range	from 31 kg / 67 lbs		
features	<ul style="list-style-type: none"> • SX Toe with TRP System • Full Diagonal • SX Heel • Dura-Coating 		

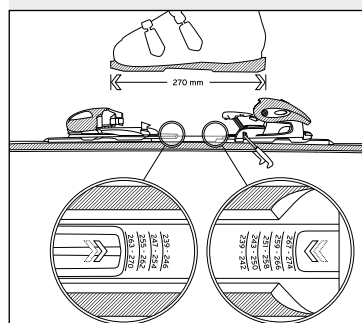

LITERAIL

If you are still hungry for more info, please read the whole menu.
Details > page 56

NOTES:

A BINDING RELATIONSHIP.

Everyone wants to be safe. Some want to be both safe and good-looking. The new line of MYA bindings are both, and feature the proven Anti Blocking System or Anti Friction Slider to provide the performance and looks every woman wants. These hot products match our MYA skis to complete the total package.



MYA 12 PRD	
art. N°	100390
color	white/black
stand height	33.5 mm
DIN	3,5-12
weight	2080 g
weight range	from 36 kg / 79lbs
features	<ul style="list-style-type: none"> • LX Toe with TRP System • Full Diagonal • ABS - Anti Blocking System • PowerRail • LD Heel • Dura-Coating

MYA 10 PR	
art. N°	100391 colors white/black
	100394 silver/turquoise
stand height	31 mm
DIN	3-10
weight	1760 g
weight range	from 31 kg / 67 lbs
features	<ul style="list-style-type: none"> • SX Toe with TRP System • Full Diagonal • AFS - Anti Friction Slider • PowerRail • SX Heel • Dura-Coating

MYA 9 LR	
art. N°	100392 colors pearl white
	100393 glittery black
stand height	28 mm
DIN	2,5-9
weight	1520 g
weight range	from 26 kg / 57 lbs
features	<ul style="list-style-type: none"> • SL Lite Toe with TRP System • Full Diagonal • ABS - Anti Blocking System • LiteRail • SL Lite Heel • Dura-Coating

GO FAST. STAY SAFE.

Kids are always moving. They can't stand still. This natural impatience is in their system. Kids' bindings should match their needs, and we've made the perfect bindings for juniors (and their parents) who are always on the move.



SL 90 ABS Junior Race	
art. N°	100347
color	white/black
stand height	21 mm
DIN	2,5-9
weight	1540 g
weight range	from 26 kg / 57 lbs
features	<ul style="list-style-type: none"> • SL Lite Toe with TRP System • Full Diagonal • ABS - Anti Blocking System • SL Lite Heel • Dura-Coating

SL 75	
art. N°	100056 colors silver/black
	100253 white/black
stand height	21 mm
DIN	2-7,5
weight	1400 g
weight range	22-84 kg / 48-187 lbs
features	<ul style="list-style-type: none"> • SL Lite Toe with TRP System • Full Diagonal • SL Lite Heel • Dura-Coating

SL 45	
art. N°	100059 colors silver/black
	100160 white/silver
stand height	15 mm
DIN	0,75-4,5
weight	1210 g
weight range	10-48 kg / 22-105 lbs
features	<ul style="list-style-type: none"> • SL Kid Toe with TRP System • Full Diagonal • SL Kid Heel • Dura-Coating



We like to think boots should be adapting to your foot, not the other way round. This insight drives all of our developments, from comfort to pure performance. Step into the next generation's footsteps.

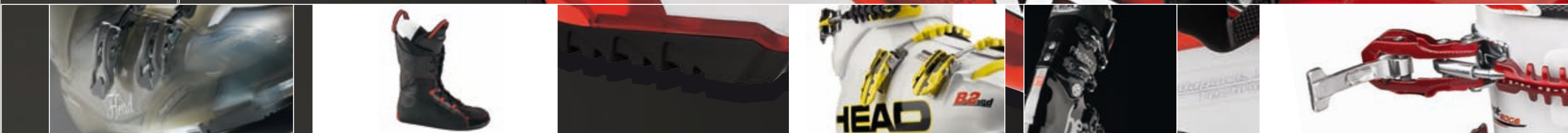

BUCKLE UP HARD.

Making boots for the fastest skiers in the world is a challenge for most companies. At HEAD, we call that a typical Tuesday. For pro level riders who want to get into our World Cup Rebels' footsteps, we've given the world's fastest boots a dazzling new look and a new innerboot construction for improved comfort and performance.



Raptor B2 RD

art. N°	601012
color	white
level	athlete
last	RD 1500cc/95
shell	PU
liner	<ul style="list-style-type: none"> • Racing Pro • Adjustable Tongue • Lacing Option • Anatomical Race Footbed • 40 mm Double Power Booster Velcro Strap
buckles	<ul style="list-style-type: none"> • 4 screwed micro-adjustable Spineflex Racing Dpt Alloy Buckles
features	<ul style="list-style-type: none"> • Flex Stance Performance Tuning • Double Canting • Rear Support Tuning • Racing Spoiler • RD Slalom Kit • FIS approved Sole Thickness
flex index	160/150/140
sizes	225-235...-285

Raptor B3 RD

art. N°	601016
color	white
level	athlete
last	RD 1500cc/95
shell	PU
liner	<ul style="list-style-type: none"> • Racing Pro • Adjustable Tongue • Lacing Option • Anatomical Race Footbed • 40 mm Double Power Booster Velcro Strap
buckles	<ul style="list-style-type: none"> • 4 screwed micro-adjustable Spineflex Racing Dpt Alloy Buckles
features	<ul style="list-style-type: none"> • Flex Stance Performance Tuning • Double Canting • Rear Support Tuning • Racing Spoiler • RD Slalom Kit • FIS approved Sole Thickness
flex index	140/130/120
sizes	225-235...-285



Raptor 130 RS

art. N°	601030
color	white
level	professional
last	RS 1800cc/98
shell	PU
liner	<ul style="list-style-type: none"> • Performance Pro • Anatomical Sport Frame footbed • 40 mm Double Power Booster Velcro Strap
buckles	<ul style="list-style-type: none"> • 4 micro-adjustable Spineflex Racing Alloy Buckles
features	<ul style="list-style-type: none"> • Flex Stance Performance Tuning • Double Canting • Rear Support Tuning • FIS approved Sole Thickness
flex index	140/130/120
sizes	220-230-240-250-255...-295-305

Raptor 115 RS

art. N°	601045
color	white
level	professional
last	RS 1800cc/98
shell	PU
liner	<ul style="list-style-type: none"> • HeatFit Pro • Anatomical Sport Frame Footbed • 40 mm Velcro Strap
buckles	<ul style="list-style-type: none"> • 4 micro-adjustable Spine-Tech Alloy Buckles
features	<ul style="list-style-type: none"> • Racing Flex Adjustment • Double Canting • FIS approved Sole Thickness
flex index	115/105
sizes	220-230-240-250-255...-295-305

NOTES:

RAPTOR FEATURES
 To view all features we rapture, simply turn the page to > **page 57**

FAST FORWARD.

Whoever said that high performance boots have to be uncomfortable clearly never skied in HEAD's Vector line. These state-of-the-art boots are the fit and performance benchmark for the all-mountain, all-day comfort skier.



SKIS | BINDINGS | BOOTS | ACCESSORIES | TECHNOLOGY

Vector 120

art. N°	601050
color	white/transparent red
level	professional
last	S 2000cc/103
shell	PU
liner	<ul style="list-style-type: none"> • SuperHeat4 • Auto Adjustable Tongue • Anatomical Sport Frame Footbed • 40 mm Double Power Booster Velcro Strap • Prepared for Heating System
buckles	<ul style="list-style-type: none"> • 4 micro-adjustable Spineflex Alloy Buckles • 2 Double Power Buckles • 1 Supermacro Ratchet
features	<ul style="list-style-type: none"> • Triple-Inj. Frame • Easy Entry Shell Design • Flex Stance Tuning • Double Canting • Rear Support Tuning
flex index	120/110
sizes	250-255...-305

Vector LTD

art. N°	601055
color	black/transparent anthracite
level	professional
last	S 2000cc/103
shell	PU
liner	<ul style="list-style-type: none"> • SuperHeat3 • Anatomical Sport Frame Footbed • 40 mm Velcro Strap • Prepared for Heating System
buckles	<ul style="list-style-type: none"> • 4 micro-adjustable Spineflex Alloy Buckles • 2 Double Power Buckles • 1 Supermacro Ratchet
features	<ul style="list-style-type: none"> • Triple-Inj. Frame • Easy Entry Shell Design • Flex Stance Tuning • Double Canting • Rear Support Tuning
flex index	110/100
sizes	250-255...-305

Vector 110

art. N°	601065	color white/transparent green
level	expert	
last	S 2000cc/103	
shell	PU	
liner	<ul style="list-style-type: none"> • HeatFit • Anatomical Frame Footbed • 40 mm Velcro Strap • Prepared for Heating System 	
buckles	<ul style="list-style-type: none"> • 4 micro-adjustable Spine-Tech Alloy Buckles • 2 Double Power Buckles • 1 Supermacro Ratchet 	
features	<ul style="list-style-type: none"> • Triple-Inj. Frame • Easy Entry Shell Design • Flex Stance Tuning • Double Canting • Rear Support Tuning 	
flex index	110/100	
sizes	250-255...-305	

Vector 100

art. N°	601085	colors white/transparent anthracite	art. N°	601087	colors black/transparent anthracite
level	expert		level	expert	
last	S 2000cc/103		last	S 2000cc/103	
shell	PU/SL		shell	PU/SL	
liner	<ul style="list-style-type: none"> • HeatFit • Anatomical Frame Footbed • 40 mm Velcro Strap • Prepared for Heating System 		liner	<ul style="list-style-type: none"> • HeatFit • Anatomical Frame Footbed • 40 mm Velcro Strap • Prepared for Heating System 	
buckles	<ul style="list-style-type: none"> • 4 micro-adjustable Spine-Tech Alloy Buckles • 1 Supermacro Ratchet 		buckles	<ul style="list-style-type: none"> • 4 micro-adjustable Spine-Tech Alloy Buckles • 1 Supermacro Ratchet 	
features	<ul style="list-style-type: none"> • Triple-Inj. Frame • Easy Entry Shell Design • Flex Tuning • Double Canting • Rear Support Tuning 		features	<ul style="list-style-type: none"> • Triple-Inj. Frame • Easy Entry Shell Design • Flex Tuning • Double Canting • Rear Support Tuning 	
flex index	100/90		flex index	100/90	
sizes	250-255...-305		sizes	250-255...-305	

NOTES:

THE FIRST SKI BOOT WITH TWO LASTS.

This season, HEAD introduces another true revolution in ski boots. Or, should we say, a revelation? In one short second, skiers can change the boot last from 104 mm to 102 mm or vice versa. Adaptive Fit is just that, a fit that adapts to skiers' different needs. For your shop, you get two-models-in-one, allowing you to simplify your buy.



AdaptEdge LTD

art. N°	601100
color	transparent anthracite/black
level	advanced
last	C 2100cc/104 and C 2100cc/102
shell	PU
liner	<ul style="list-style-type: none"> • SuperHeat4 • Anatomical Frame Footbed • 40 mm Double Power Booster Velcro Strap • Prepared for Heating System
buckles	<ul style="list-style-type: none"> • 4 micro-adjustable Spine-Tech Alloy Buckles • 2 Double Power Buckles • 1 Supermacro Ratchet
features	<ul style="list-style-type: none"> • Adaptive Fit Technology • Triple-Inj. Energy Frame • Easy Entry Shell Design • Stiffer/Softer Flex Adjustment • Double Canting • Adjustable Rear Spoiler • SoftWalk Heel + Grip System
flex index	110/100
sizes	250-260-265-...-305

AdaptEdge 100

art. N°	601110
color	transparent red/white
level	advanced
last	C 2100cc/104 and C 2100cc/102
shell	PU/SL
liner	<ul style="list-style-type: none"> • HP HeatFit • Anatomical Frame Footbed • 35 mm Velcro Strap • Prepared for Heating System
buckles	<ul style="list-style-type: none"> • 4 micro-adjustable Spine-Tech Alloy Buckles • 2 Double Power Buckles • 1 Supermacro Ratchet
features	<ul style="list-style-type: none"> • Adaptive Fit Technology • Triple-Inj. Energy Frame • Easy Entry Shell Design • Stiffer/Softer Flex Adjustment • Double Canting • Adjustable Rear Spoiler • SoftWalk Heel + Grip System
flex index	100/90
sizes	250-260-265-...-305-310-320-330-340

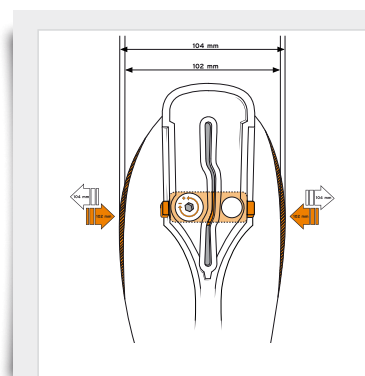

ADAPTIVE FIT TECHNOLOGY

There is obviously more to the revolution than just the flashy headline. Read it all. **Details > page 58**



AdaptEdge 90

art. N°	601142	colors	black/white/transparent anthracite
	601144		white/transparent anthracite/yellow
level	advanced		
last	C 2100cc/104 and C 2100cc/102		
shell	SL		
liner	<ul style="list-style-type: none"> • HeatFit • HP Anatomical Footbed • 35 mm Velcro Strap • Prepared for Heating System • 4 micro-adjustable Alloy Buckles • 2 Double Power Buckles • 1 Supermacro Ratchet • Adaptive Fit Technology • Triple-Inj. Energy Frame • Easy Entry Shell Design • Stiffer/Softer Flex Adjustment • Double Canting • Adjustable Rear Spoiler • SoftWalk Heel + Grip System 		
flex index	90/80		
sizes	250-260-265-...-305		

NextEdge 80

art. N°	601175	color	black/white/transparent anthracite
level	advanced		
last	C 2100cc/104		
shell	SL		
liner	<ul style="list-style-type: none"> • Comfort • HP Anatomical Footbed • 35 mm Velcro Strap • Prepared for Heating System • 4 micro-adjustable Alloy Buckles • 1 Supermacro Ratchet 		
buckles	<ul style="list-style-type: none"> • Triple-Inj. Energy Frame • Easy Entry Shell Design • Double Canting • SoftWalk Heel 		
flex index	80		
sizes	250-260-265-...-305		



NextEdge 70

art. N°	601230	colors	white/black
	601235		black/anthracite
level	intermediate		
last	C 2100cc/104		
shell	SL		
liner	<ul style="list-style-type: none"> • Comfort • HP Anatomical Footbed • 35 mm Velcro Strap • Prepared for Heating System • 4 micro-adjustable Alloy Buckles • 1 Supermacro Ratchet • Triple-Inj. Energy Frame • Easy Entry Shell Design • Double Canting • SoftWalk Heel 		
buckles	<ul style="list-style-type: none"> • Triple-Inj. Energy Frame • Easy Entry Shell Design • Double Canting • SoftWalk Heel 		
flex index	70		
sizes	250-260-265-...-305		

HIGH PERFORMANCE NEVER LOOKED SO COOL.

Freeskiers want maximum shock absorption to stick big landings, but will never sacrifice performance to simply look cool. With three distinct fits, we have the perfect project for every free-skiing phenom.



Raptor Project RS

art. N°	601047
color	black
level	professional
last	RS 1800cc/98
shell	PU
liner	<ul style="list-style-type: none"> • HeatFit Pro • Anatomical Frame Footbed • 40 mm Velcro Strap
buckles	<ul style="list-style-type: none"> • 4 micro-adjustable Spine-Tech Alloy Buckles
features	<ul style="list-style-type: none"> • Racing Flex Adjustment • Rubber Inserts • Double Canting • Shock Bumper Wedge
flex index	115/105
sizes	230-240-250-255-...-295-305

Edge Project

art. N°	601170
color	white
level	advanced
last	C 2100cc/104
shell	SL
liner	<ul style="list-style-type: none"> • HeatFit • HP Anatomical Footbed • 35 mm Velcro Strap • Prepared for Heating System
buckles	<ul style="list-style-type: none"> • 4 micro-adjustable Spine-Tech Alloy Buckles • 1 Supermacro Ratchet
features	<ul style="list-style-type: none"> • Triple-Inj. Energy Frame • Easy Entry Design • Double Canting • SoftWalk Heel • Shock Bumper Wedge
flex index	80
sizes	250-260-265-...-305

NOTES:

ALL DAY LONG.

These boots weren't just made for speeding, they were made for walking, too... and for everything before, after and in between. This is the most travel-friendly ski boot on the market.



i-Type 12.5

art. N°	601330
color	black
level	advanced
last	EC 2200cc/106
shell	SL
liner	<ul style="list-style-type: none"> • SuperHeat3 Front Entry • Fur Lining • Fleece Anatomical Footbed • 35 mm Velcro Strap • Prepared for Heating System
buckles	<ul style="list-style-type: none"> • 1 micro-adjustable Double Power Alloy Buckle • 1 Double Memory Buckle • 2 Supermacro Ratchets
features	<ul style="list-style-type: none"> • FlexWalkingSole • ISO 5355 Vibram Pads • AutoSkiWalk • Adjustable Rear Spoiler
flex index	80
sizes	260-265-...-305

i-Type 10.5

art. N°	601350
color	white
level	intermediate
last	EC 2200cc/106
shell	SL
liner	<ul style="list-style-type: none"> • HeatFit Rear Entry • Fleece Lining • HP Anatomical Footbed • 35 mm Velcro Strap
buckles	<ul style="list-style-type: none"> • 1 micro-adjustable Double Power Alloy Buckle • 1 Double Memory Buckle • 2 Supermacro Ratchets
features	<ul style="list-style-type: none"> • FlexWalkingSole • SoftWalk Heel + Grip System • AutoSkiWalk • Rear Spoiler
flex index	70
sizes	250-255-...-310-320

i-Type 8.5

art. N°	601370
color	black/red
level	intermediate
last	EC 2200cc/106
shell	SL
liner	<ul style="list-style-type: none"> • Comfort Rear Entry • Fleece Lining • HP Anatomical Footbed • 35 mm Velcro Strap
buckles	<ul style="list-style-type: none"> • 1 micro-adjustable Plastic Buckle • 1 Double Memory Buckle • 2 Supermacro Ratchets
features	<ul style="list-style-type: none"> • FlexWalkingSole • SoftWalk Heel + Grip System • AutoSkiWalk • Rear Spoiler
flex index	60
sizes	250-255-...-305

i-TYPE TECHNOLOGY
 Fitting three boots into one is a kind of magic, but we'll explain in full all the tricks up our sleeves. **Details > page 59**

SHE SAID.

HEAD's women's-specific ski boots are just that, 100% for women. Our Dream series are still the only boots that feature a shell developed especially for women's feet. We also take the award-winning, best-selling Vector, AdaptEdge, and i-Type shells and load them with women's specific features to complete our line up. Our women's collection is the perfect blend of beauty and performance.



Vector 100 one

art. N°	601088
color	transparent anthracite
level	expert
last	S 2000cc/103
shell	PU/SL
liner	<ul style="list-style-type: none"> • Women's HeatFit • Anatomical Frame Footbed • 40 mm Velcro Strap • Prepared for Heating System
buckles	<ul style="list-style-type: none"> • 4 micro-adjustable Spine-Tech Alloy Buckles • 1 Supermacro Ratchet
features	<ul style="list-style-type: none"> • Double-Inj. Frame • Easy Entry Design • Flex Tuning • Double Canting • Women's-specific Supportive Heel Option
flex index	90/80
sizes	230-235-...-275

Dream 12.5 one

art. N°	600510
color	transparent pearl
level	professional
last	WP 1950cc/102
shell	PU
liner	<ul style="list-style-type: none"> • Women's SuperHeat3 • Fur Lining and Thermaluxe Tips • Fleece Anatomical Footbed • 30 mm Double Power Velcro Strap • Prepared for Heating System
buckles	<ul style="list-style-type: none"> • 4 micro-adjustable Magnesium Buckles • 2 Double Power Buckles • 1 Supermacro Ratchet • Easy Entry Instep Ratchet
features	<ul style="list-style-type: none"> • Stiffer/Softer Flex Adjustment • Adjustable Wedge Arch Support • Double Canting • Double Adjustable Profile • SoftWalk Heel + Grip System • Women's-specific Supportive Heel Option
flex index	100/90
sizes	220-230-235-...-275



Dream 10.5 one

art. N°	601525
color	transparent anthracite
level	expert
last	WP 1950cc/102
shell	PU/SL
liner	<ul style="list-style-type: none"> • Women's HeatFit • Fleece Lining and Thermaluxe Tips • Self Shaping Footbed with Sanitized® • 30 mm Velcro Strap • Prepared for Heating System
buckles	<ul style="list-style-type: none"> • 4 micro-adjustable Magnesium Buckles • 2 Double Power Buckles • 1 Supermacro Ratchet • Easy Entry Instep Ratchet
features	<ul style="list-style-type: none"> • Stiffer/Softer Flex Adjustment • Adjustable Wedge Arch Support • Double Canting • Double Adjustable Profile • SoftWalk Heel + Grip System • Women's-specific Supportive Heel Option
flex index	90/80
sizes	220-230-235-...-275



Dream 9.5 one

art. N°	601530
color	mocha
level	expert
last	WP 1950cc/102
shell	SL
liner	<ul style="list-style-type: none"> • Women's HeatFit • Fleece Lining and Thermaluxe Tips • Self Shaping Footbed with Sanitized® • 30 mm Velcro Strap • Prepared for Heating System
buckles	<ul style="list-style-type: none"> • 4 micro-adjustable Magnesium Buckles • 2 Double Power Buckles • 1 Supermacro Ratchet • Easy Entry Instep Ratchet
features	<ul style="list-style-type: none"> • Stiffer/Softer Flex Adjustment • Adjustable Wedge Arch Support • Double Canting • Double Adjustable Profile • SoftWalk Heel + Grip System • Women's-specific Supportive Heel Option
flex index	80/70
sizes	220-230-235-...-275



Dream 8.5 one

art. N°	600560
color	pearl/anthracite
level	advanced
last	WP 1950cc/102
shell	SL
liner	<ul style="list-style-type: none"> • Women's HeatFit • Fleece Lining and Thermaluxe Tips • Self Shaping Footbed with Sanitized® • 30 mm Velcro Strap • Prepared for Heating System • Therm-ic® Sole available
buckles	<ul style="list-style-type: none"> • 4 micro-adjustable Magnesium Buckles • 1 Supermacro Ratchet • Easy Entry Instep Ratchet
features	<ul style="list-style-type: none"> • Adjustable Wedge Arch Support • Double Canting • Double Adjustable Profile • SoftWalk Heel • Women's-specific Supportive Heel Option
flex index	70
sizes	220-230-235-...-275

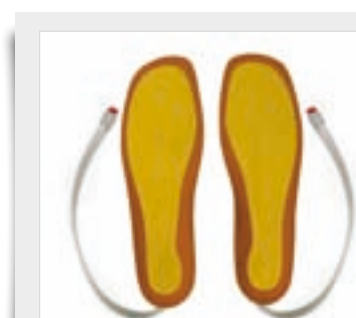

THERM-IC® SOLE

Simply plug in a power pack for comfy heat - no more cold feet! The new Therm-ic® Sole is available for art N° 600560, 601145 and 601245.



AdaptEdge 100 one

art. N°	601115
color	transparent pearl
level	advanced
last	C 2100cc/104 and C 2100cc/102
shell	PU/SL
liner	<ul style="list-style-type: none"> • Women's HP HeatFit • Fur Lining • 30 mm Velcro Strap • Prepared for Heating System
buckles	<ul style="list-style-type: none"> • 4 micro-adjustable Spine-Tech Alloy Buckles • 2 Double Power Buckles • 1 Supermacro Ratchet
features	<ul style="list-style-type: none"> • Adaptive Fit Technology • Triple-Inj. Energy Frame • Easy Entry Shell Design • Stiffer/Softer Flex Adjustment • Double Canting • Double Adjustable Profile • Adjustable Rear Spoiler • SoftWalk Heel + Grip System • Women's-specific Supportive Heel Option
flex index	90/80
sizes	220-230-235-...-275

AdaptEdge 90 one

art. N°	601145
color	pearl/transparent white
level	advanced
last	C 2100cc/104 and C 2100cc/102
shell	SL
liner	<ul style="list-style-type: none"> • Women's HP HeatFit • Fur Lining • 30 mm Velcro Strap • Prepared for Heating System • Therm-ic® Sole available
buckles	<ul style="list-style-type: none"> • 4 micro-adjustable Alloy Buckles • 2 Double Power Buckles • 1 Supermacro Ratchet
features	<ul style="list-style-type: none"> • Adaptive Fit Technology • Triple-Inj. Energy Frame • Easy Entry Shell Design • Stiffer/Softer Flex Adjustment • Double Canting • Double Adjustable Profile • Adjustable Rear Spoiler • SoftWalk Heel + Grip System • Women's-specific Supportive Heel Option
flex index	80/70
sizes	220-230-235-...-275

NextEdge 80 one

art. N°	601185	color	mocha/transparent anthracite
level	advanced		
last	C 2100cc/104		
shell	SL		
liner	<ul style="list-style-type: none"> • Women's Comfort • Fleece Lining • 30 mm Velcro Strap • Prepared for Heating System 		
buckles	<ul style="list-style-type: none"> • 4 micro-adjustable Alloy Buckles • 1 Supermacro Ratchet 		
features	<ul style="list-style-type: none"> • Triple-Inj. Energy Frame • Easy Entry Shell Design • Double Canting • Double Adjustable Profile • SoftWalk Heel • Women's-specific Supportive Heel Option 		
flex index	70		
sizes	220-230-235-...-275		

NextEdge 70 one

art. N°	601242	colors	pearl/silver
level	intermediate		
last	C 2100cc/104		
shell	SL		
liner	<ul style="list-style-type: none"> • Women's Comfort • Fleece Lining • 30 mm Velcro Strap • Prepared for Heating System • Therm-ic® Sole available for art. N° 601245 		
buckles	<ul style="list-style-type: none"> • 4 micro-adjustable Plastic Buckles • 1 Supermacro Ratchet 		
features	<ul style="list-style-type: none"> • Triple-Inj. Energy Frame • Easy Entry Shell Design • Double Canting • Double Adjustable Profile • SoftWalk Heel • Women's-specific Supportive Heel Option 		
flex index	60		
sizes	220-230-235-...-275		

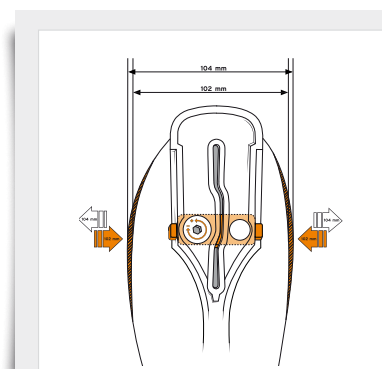

ADAPTIVE FIT TECHNOLOGY
The first boot with two lasts.
Details > page 58

NOTES:



**i-Type
12.5 one**

art. N°	601330
color	black
level	advanced
last	EC 2200cc/106
shell	SL
liner	<ul style="list-style-type: none"> • Women's SuperHeat3 Front Entry • Fur Lining • Fleece Anatomical Footbed • 35 mm Velcro Strap • Prepared for Heating System
buckles	<ul style="list-style-type: none"> • 1 micro-adjustable Double Power Alloy Buckle • 1 Double Memory Buckle • 2 Supermacro Ratchets
features	<ul style="list-style-type: none"> • FlexWalkingSole • ISO 5355 Vibram Pads • AutoSkiWalk • Women's-specific Supportive Heel Option
flex index	70
sizes	230-235-...-255

**i-Type
10.5 one**

art. N°	601355
color	silver/gold
level	intermediate
last	EC 2200cc/106
shell	SL
liner	<ul style="list-style-type: none"> • Women's HeatFit Rear Entry • Fleece Lining • Sanitized® Self Shaping Footbed • 35 mm Velcro Strap
buckles	<ul style="list-style-type: none"> • 1 micro-adjustable Double Power Alloy Buckle • 1 Double Memory Buckle • 2 Supermacro Ratchets
features	<ul style="list-style-type: none"> • FlexWalkingSole • SoftWalk Heel + Grip System • AutoSkiWalk • Women's-specific Supportive Heel Option
flex index	60
sizes	230-235-...-275

**i-Type
8.5 one**

art. N°	601376
color	pearl
level	intermediate
last	EC 2200cc/106
shell	SL
liner	<ul style="list-style-type: none"> • Women's Comfort Rear Entry • Fleece Lining • Sanitized® Self Shaping Footbed • 35 mm Velcro Strap
buckles	<ul style="list-style-type: none"> • 1 micro-adjustable Plastic Buckle • 1 Double Memory Buckle • 2 Supermacro Ratchets
features	<ul style="list-style-type: none"> • FlexWalking Sole • SoftWalk Heel + Grip System • AutoSkiWalk • Women's-specific Supportive Heel Option
flex index	50
sizes	230-235-...-275



BRAVE AT HEART.

Kids like to have fun. But kids like to be good at what they do, too. Skiing is no exception, so we've made our boots a little cooler with features like Spine-Tech buckles or sticker kits - whether you have a future star, or a future fireside sleeper, we have the boot to keep your kid happy and cosy.



**Raptor
90**

art. N°	601610
color	white
level	professional
last	RS 1800cc/98
shell	PU
liner	<ul style="list-style-type: none"> • Jr HeatFit Pro • Anatomical Sport Frame Footbed • 40 mm Velcro Strap • 4 micro-adjustable Spine-Tech Alloy Buckles • Jr Racing Flex Adjustment • Jr Cuff • Double Canting • FIS approved Sole Thickness • Adult Norm
flex index	90/80
sizes	220-225-...-275

**Raptor
70**

art. N°	601615
color	white
level	expert
last	Junior Racing
shell	SL
liner	<ul style="list-style-type: none"> • Junior Team • 30 mm Velcro Strap
buckles	<ul style="list-style-type: none"> • 4 micro-adjustable Spine-Tech Alloy Buckles • Jr Racing Flex Adjustment • Adult Norm (size 220 up)
features	
flex index	70/60
sizes	200-210-220-225-...-265

NOTES:



Raptor Project J

art. N°	600620
color	white
level	expert
last	Junior Racing
shell	SL
liner	<ul style="list-style-type: none"> • Junior Team • 30 mm Velcro Strap
buckles	• 4 Plastic Buckles
features	<ul style="list-style-type: none"> • Jr Racing Flex Adjustment • Adult Norm (size 220 up)
flex index	60
sizes	200-210-220-225-...-265



Raptor 50

art. N°	601625
color	white
level	advanced
last	Junior Racing
shell	SL
liner	• Junior Team
buckles	• 4 Plastic Buckles
features	<ul style="list-style-type: none"> • Jr Racing Flex Adjustment • Adult Norm (size 220 up)
flex index	50
sizes	200-210-220-225-...-265



Edge J2

art. N°	601670	colors black/white
	601672	white/red
	601675	white/silver
	601680	yellow/blue
level	beginner	
last	Junior	
shell	SL	
liner	<ul style="list-style-type: none"> • Junior • Tongue Handle • Comfort Footbed 	
buckles	• 2 Plastic Buckles	
features	<ul style="list-style-type: none"> • Easy Entry Shell Construction • Kids' SkiWalk • Junior Norm • Design Your Boots Stickers 	
flex index	-	
sizes	195-205-215-225	

Edge J3

art. N°	601650	colors black/white
	601652	white/red
	601655	white/silver
level	intermediate	
last	Junior	
shell	SL	
liner	<ul style="list-style-type: none"> • Junior • Tongue Handle • Comfort Footbed 	
buckles	• 3 Plastic Buckles	
features	<ul style="list-style-type: none"> • Easy Entry Shell Construction • SoftWalk Heel • Adult Norm 	
flex index	-	
sizes	230-235-...-265	



Edge J1

art. N°	601690	colors black/white
	601692	white/red
	601695	white/silver
	601699	yellow/blue
level	beginner	
last	Junior	
shell	SL	
liner	<ul style="list-style-type: none"> • Junior • Tongue Handle • Comfort Footbed 	
buckles	• 1 Plastic Buckle	
features	<ul style="list-style-type: none"> • Easy Entry Shell Construction • Kids' SkiWalk • Junior Norm • Design Your Boots Stickers 	
flex index	-	
sizes	155-165-175-185	



It's the small things in life that make a big difference. This is why we pack as much thought into our accessories as we put into our hardware.



STICK AROUND.

When it comes to building poles, you've gotta be tough, but you've also gotta be light. At HEAD, we're tough and light, like a bantamweight fighter. With our all-new fat&PIPE pole, featuring cut-to-fit technology, you can easily cut through the crud and make this pole your own custom length.

i. Carbon

art. N°	381041	color	carbon anthracite/silver
Ø	Carbon 11 mm		
lengths	105 - 135 cm		
features	<ul style="list-style-type: none"> • New design • 11 mm diameter • New Positive Angle Safety • Thermo Grip with matt chrome finish • Carbide Flex Tip • Vision 50 mm Race Basket 		



WC Super G

art. N°	381021	color	white/black/red
Ø	18 mm/bent		
lengths	105 - 135 cm		
features	<ul style="list-style-type: none"> • New design • 7075 Aluminum • Soft Downhill Grip • Race Strap • DH & SG Cone Basket 40 mm • Carbide Tip 		

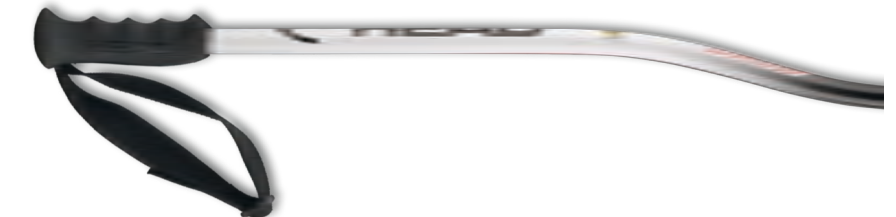

Supershape SL

art. N°	381031	color	white/red/black
Ø	18 mm		
lengths	105 - 135 cm		
features	<ul style="list-style-type: none"> • New design • 7075 Aluminum • Soft Downhill Grip • Race Strap • Race Basket 50 mm • Carbide Tip 		

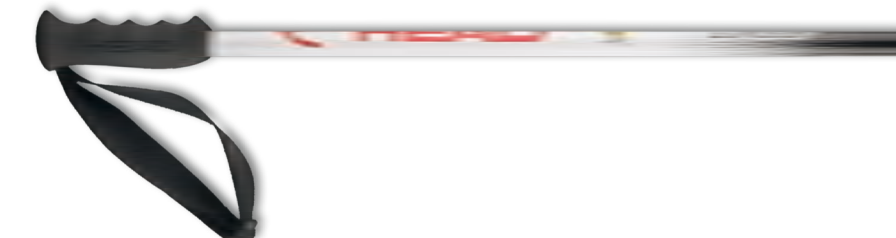

Supershape VIP

art. N°	381131	color	black/silver/orange
Ø	16 mm AIRFOIL		
lengths	105 - 135 cm		
features	<ul style="list-style-type: none"> • New design • Air Foil Profile • 7075 Aluminum • New Positive Angle Safety • Thermo Grip with matt chrome finish • Carbide Tip • 50 mm Race Basket 		



Supershape Vario

art. N°	381511	color	black/anthracite/silver/red
Ø	16/14 mm		
lengths	adj. 110 - 140 cm (Packing 84 cm)		
features	<ul style="list-style-type: none"> • New design • Two-Part Telescope Pole with Speed Lock • New Positive Angle Safety • Thermo Grip with matt chrome finish • Carbide Flex Tip • Vision 50 mm Race Basket • Additional 95 mm Powder Basket 		



fat&PIPE

art. N°	381331	color	green/teal/pink
Ø	22 mm not tapered		
length	135 cm only		
features	<ul style="list-style-type: none"> • New model • length 135 only • Cut-to-Fit • 22 mm not tapered • Machined Barrel Tip with Basket Thread and Carbide Tip • 2 changeable baskets (50 & 92 mm) • Barrel PIPE Grip w/o Strap 		



multi S

art. N°	381111	colors	silver/black/antracite
	381121		silver/red/black
Ø	18 mm		
lengths	105 - 135 cm		
features	<ul style="list-style-type: none"> • New design • 5083 Aluminum • Bi-Injected Grip • Automatic Strap • 50 mm Race Basket • Star Steel Tip 		



multi

art. N°	381211	colors	black/red/white
	381221		silver/red/black
	381231		anthracite/silver/black
Ø	18 mm		
lengths	105 - 135 cm		
features	<ul style="list-style-type: none"> • New design • 5086 Aluminum • Ergo PE Grip • Automatic Strap • 50 mm Race Basket • Star Steel Tip 		



MYA black

art. N°	381601	color	black/white/silver
Ø	16 mm		
lengths	110 - 130 cm		
features	<ul style="list-style-type: none"> • New design • 7075 Aluminum • New Positive Angle Safety Thermo Grip with matt chrome finish • Ice Steel Tip • 50 mm Race Basket 		



MYA white black

art. N°	381671	color	white/black
Ø	16 mm		
lengths	105 - 125 cm		
features	<ul style="list-style-type: none"> • New design • 5086 Aluminum • Woman SBS Soft Grip • Automatic Strap • 50 mm Race Basket • Star Steel Tip 		



WC Supershape SG Junior

art. N°	381321	color	white/black/red
Ø	16 mm/bent		
lengths	90 - 110 cm		
features	<ul style="list-style-type: none"> • New design • 5086 Aluminum • Soft Downhill Grip • Buckle Strap • DH & SG Cone Basket 40 mm • Steel Tip 		



Supershape Team

art. N°	381371	color	white/red/black
Ø	14 mm		
lengths	90 - 110 cm		
features	<ul style="list-style-type: none"> • New design • 5086 Aluminum • Kids' Grip • Buckle Strap • Race Basket 50 mm • Steel Tip 		



Mojo Team

art. N°	381361	color	white/multicolor
Ø	14 mm		
lengths	90 - 110 cm		
features	<ul style="list-style-type: none"> • New design • 5086 Aluminum • Kids' Grip • Buckle Strap • Race Basket 50 mm • Steel Tip 		



MYA one

art. N°	381381	color	blue/pink
Ø	14 mm		
lengths	90 - 110 cm		
features	<ul style="list-style-type: none"> • New design • 5086 Aluminum • Kids' Grip • Buckle Strap • Race Basket 50 mm • Steel Tip 		



NOTES:

PACK ATTACK.

To take the world by storm, one has to travel it. Make sure you do in style and ease with our rebels-approved line of travel bags. These are made for you, because we know energy should be spent on the mountain, not on the way there.

REBELS' LINE



Rebels' Travelbag

art. N°	383501
dimensions	84 x 34 x 40 cm
volume	72 l
description	Big wheelee bag for ski pros and world travellers. Stowable telescope handle for easy pulling. Padded heavy-duty casing. High quality wheels.

Rebels' Racing Backpack

art. N°	383631
dimensions	40 x 50 x 34 cm
volume	41 l
description	Big backpack for racers, coaches and tech-reps. Equipped with padded dorsal straps and backing, organizer and various utility compartments.

Rebels' Backpack

art. N°	383531
dimensions	32 x 48 x 18 cm
volume	19 l
description	Functional Pro freeride daypack with various utility compartments (for goggles, digi cams, etc), stowable helmet net and water resistant protectice shell. 4 diagonal ski or snowboard straps.



Heatable Ski Boot Bag

art. N°	383540
dimensions	45 x 28 x 45 cm
volume	42 l
description	Shapely boot-carry-on-bag with heating elements. Various utility compartments and adjustable helmet holder. Power: 110V or 220V DC / Automotive: 12V AC. Temperature: Three temperature settings: Hot (70°C/150°F), Dry (60°C/130°F), Warm (50°C/122°F)



Rebels' Double Skibag

art. N°	383521
dimensions	195(223) x 40 x 16 cm
volume	116 l
description	Protective bag for 2 pairs of racing skis. Business card window and padded main compartment. Extendable to a length of 223 cm.

PERFORMANCE LINE



Ski Travelbag

art. N°	383701
dimensions	80 x 36 x 37 cm
volume	79 l
description	Big wheelee bag with a large zippered main compartment and other compartments. Stowable pull handle. Business card window and high quality wheels.

Ski Daypack

art. N°	383741
dimensions	31 x 23 x 23 cm
volume	17 l
description	Daypack with zippered main and external compartment. Ergonomic mesh back padding.

Boot Bag

art. N°	383751
dimensions	40 x 40 x 27 cm
volume	31 l
description	Shapely boot-carry-on-bag with comfortable handles and shoulder strap. Zippered main and external compartment.

Single Ski Bag 170

art. N°	383711
dimensions	178 x 22 x 12 cm
volume	41 l
description	Protective Skibag for one pair of skis. Equipped with two buckled, easy-to-adjust compression straps and a comfortable carrying strap.



Single Ski Bag 190

art. N°	383721
dimensions	196 x 22 x 12 cm
volume	53 l
description	Protective Skibag for one pair of skis. Equipped with two buckled, easy-to-adjust compression straps and a comfortable carrying strap.

Double Ski Bag

art. N°	383731
dimensions	177(195) x 30 x 12 cm
volume	67 l
description	Protective bag for two pairs of skis. Equipped with two buckled, easy-to-adjust compression straps and a comfortable carrying strap. Extendable to a length of 195 cm.

Boot Backpack

art. N°	383761
dimensions	36 x 40 x 27 cm
volume	26 l
description	Ski boot backpack with padded dorsal straps. Roomy zippered compartment and external zippered pouch. Backing ergonomically padded.



Wallet

art. N°	383771
Dimension	8 x 12 cm
volume	-
description	Slick wallet with change, credit card and snowcat license compartment.



WOMEN'S LINE



Women's Travelbag

art. N°	383801
dimensions	73 x 36 x 37 cm
volume	67 l
description	Women-specific wheelee bag with telescope handle for easy pulling. Large zippered main compartment and various inner and outer compartments. High quality wheels.



Women's Boot Bag

art. N°	383831
dimensions	40 x 38 x 27 cm
volume	30 l
description	Boot bag for one pair of boots. Ergonomic shoulder strap. Zippered main and external compartment.



Women's Single Ski Bag

art. N°	383811
dimensions	187 x 24 x 12 cm
volume	60 l
description	A women-specific skibag for one pair of skis. Comfortable carrying straps and solid compression straps.

Women's Handbag

art. N°	383821
dimensions	36 x 28 x 15 cm
volume	8 l
description	Small handbag with adjustable shoulder straps. Zippered main compartment and 2 small outside compartments with an organizer.

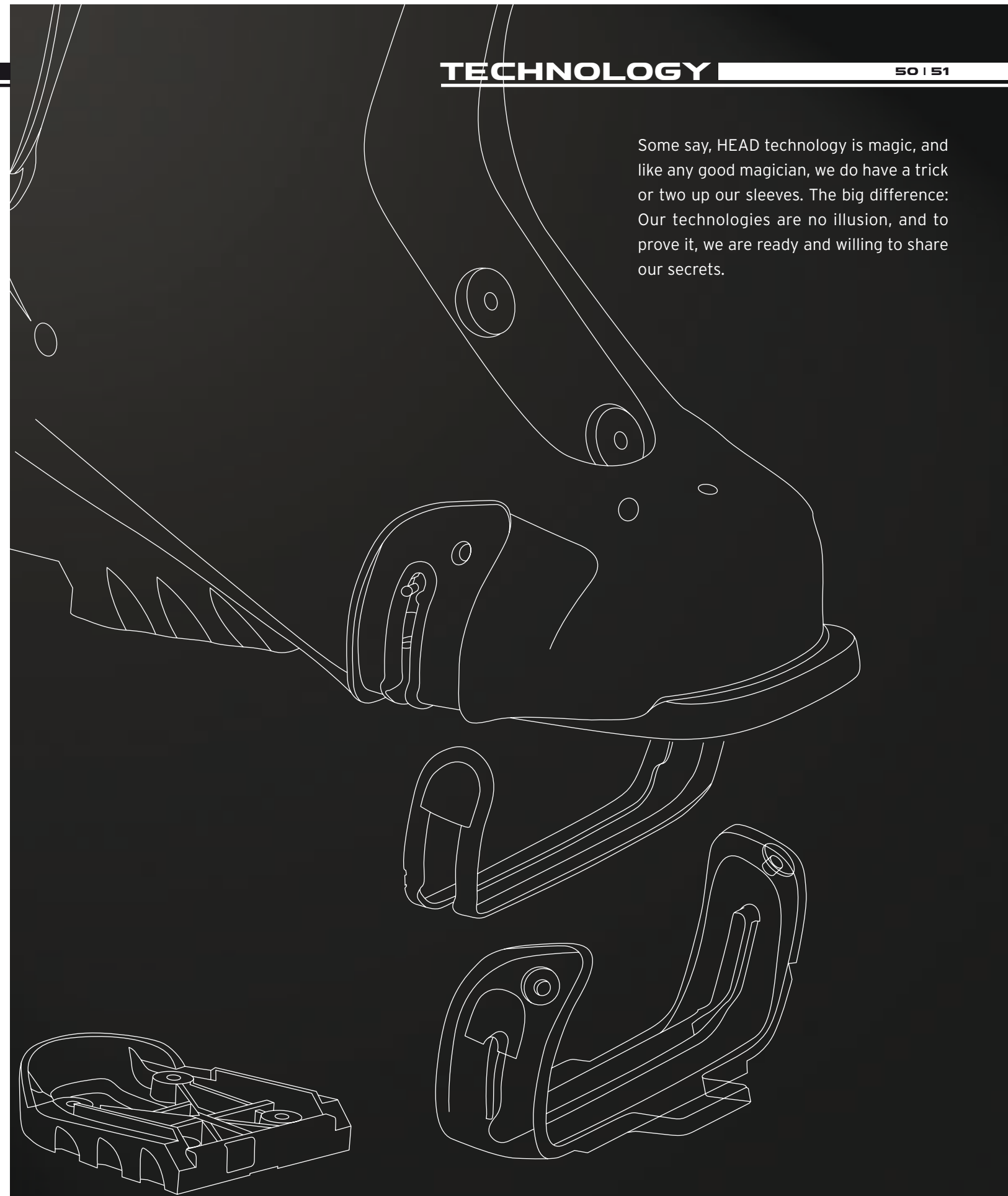

Some say, HEAD technology is magic, and like any good magician, we do have a trick or two up our sleeves. The big difference: Our technologies are no illusion, and to prove it, we are ready and willing to share our secrets.

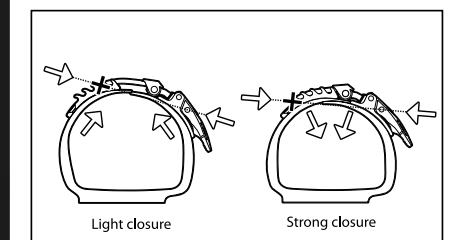
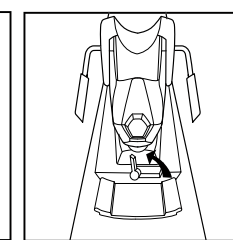
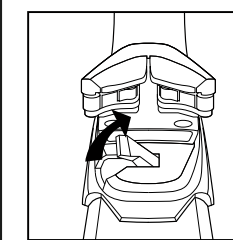
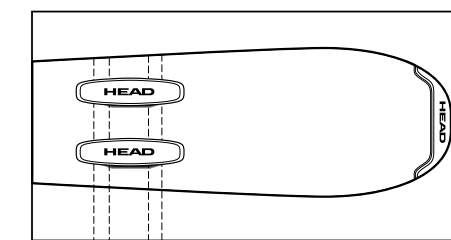

SKI TECHNOLOGY:

KERS Technology

THE EXTRA BOOST

KERS Technology works like a turbo charger that provides additional power and acceleration by stiffening the tail of the ski in outturns. The effect: a boost, catapulting the rider into the next turn. Just like when Formula 1 pilots push a button for that extra notch of speed. HEAD KERS Technology is an electronic, fully automatic and integrated system.

TECHNICAL BACKGROUND

HEAD KERS Technology is an evolution of the idea behind HEAD's Intelligence Technology. But unlike Intelligence, KERS does not influence the torsional

stiffness of the ski, KERS empowers the skis' longitudinal flex. Also KERS Technology is based on a completely new chip capable of accumulating power and keeping it in store for the right moment.

Piezoelectric fibers transform kinetic energy into electrical energy which is stored in the embedded chip in the ski. Electrical energy is immediately released to areas of the ski, where additional energy is requested by the sensor. Timing and release are automatically controlled and coordinated. Depending on the flex pattern of different ski models, sensors are programmed beforehand: the more aggressive the ski has to be, the stiffer the tail will become.

HOW IT WORKS

Skis experience maximum flex at the end of a turn. At this moment an active microchip releases energy into the fibers of the tail. The tail of the ski then

stiffens up, immediately increasing rebound for maximum acceleration at the end of the outturn.

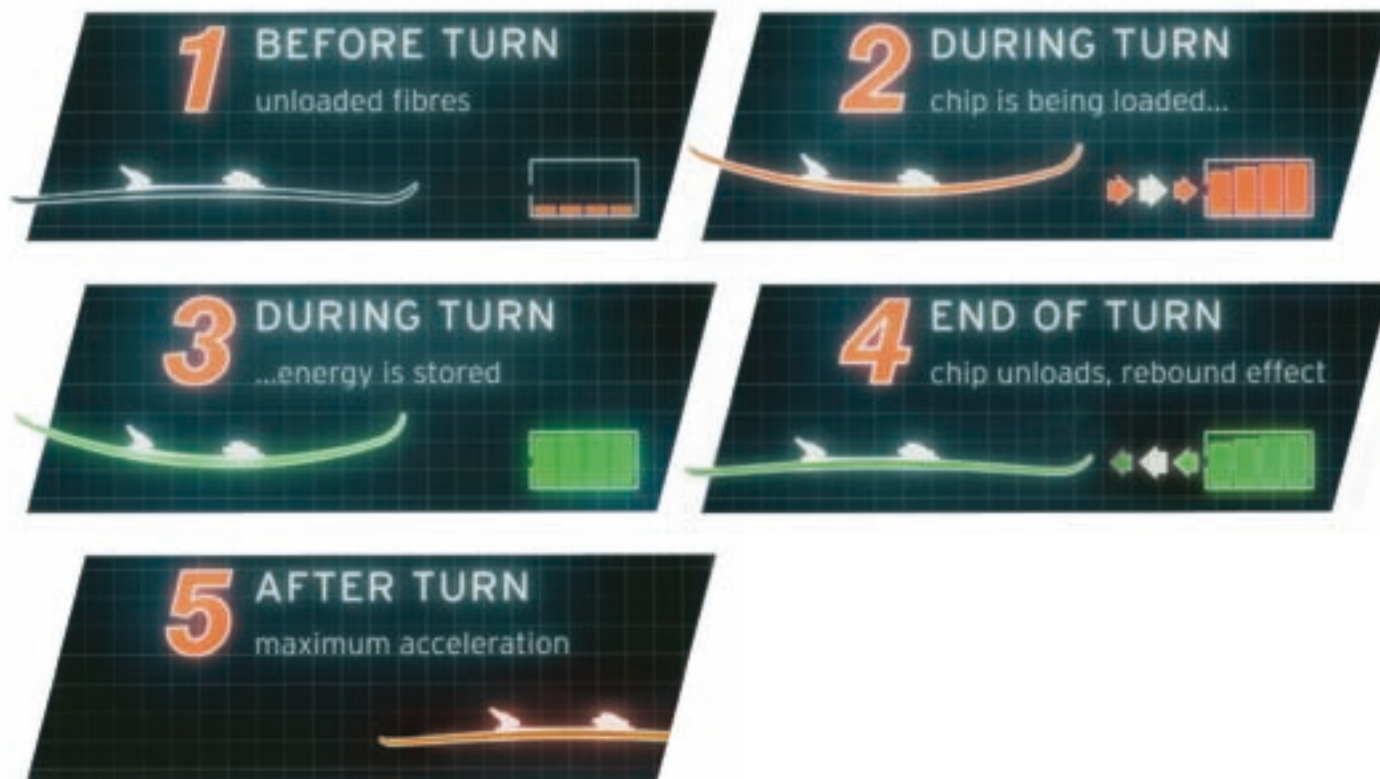

SKI TECHNOLOGY:

FLR Technology

Every skier is on a quest for fun. For some, it's chest-deep powder, while others want to rip down groomers. No matter where you ski, HEAD's FLR Technology helps you find the action.

The FLR family consists of three profiles: Flow Ride, Flow Rise, and Flow Rocker.

HOW IT WORKS

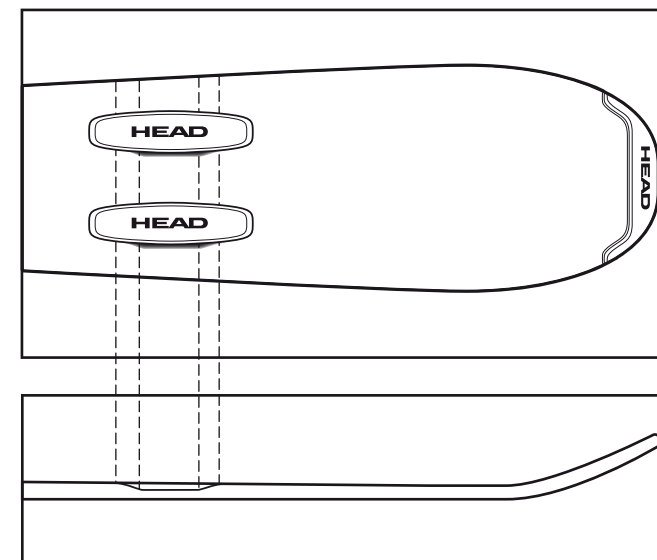

FLOW RIDE

Flow Ride gives skiers "rocker when you want it, and stability when you need it." Simply put, these skis are fun, fun, fun for everyone.

Flow Ride blends the superior edge hold of traditional "bowed" camber with the floatation of rocker, putting the skier in complete harmony with the mountain. Flow Ride is the most versatile of the three FLR core profiles, and is equally at home in the Rockies as it is in the Alps.

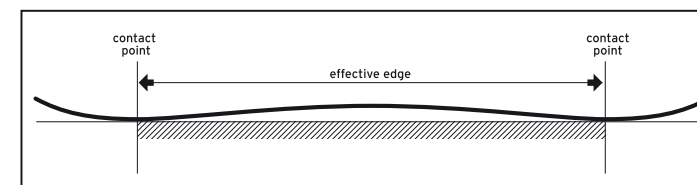

FLOW RISE

Flow Rise combines early rise rocker with traditional camber. This profile utilizes a longer rise in the tip for increased float in powder with a shorter rise in the tail for surefooted landings. Through the mid-body of the ski, traditional camber is used to maintain edge-hold and rebound for groomed slopes.

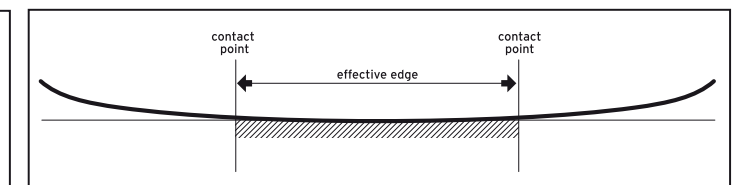

FLOW ROCKER

Flow Rocker is full-length rocker that starts at the bindings, and works its way to the ends of the ski (that's right, like a rocking chair...). The effective edge is shorter, but the large surface of this powder ski profile gives the skier the stability they need for the gnarliest of the gnar.

The result is a profile that surfs powder and smears turns with the greatest of ease.

BINDING TECHNOLOGY:

HEAD Kinematics in LX and SX Toes

THE NEXT BIG STEP IN BINDINGS

As the worldwide leaders in binding sales and technology, we believe in challenging the status quo. Not just in the safety, convenience, or aesthetics of our products, but also in the performance. To this end, for 2011/2012 we have reinvented our S and L toes, and raised the standard - again.

Introducing the new HEAD SX and LX toes:
They don't just look smart and solid, they also have a completely new kinematic layout to match. These new toes offer:

HOW IT WORKS

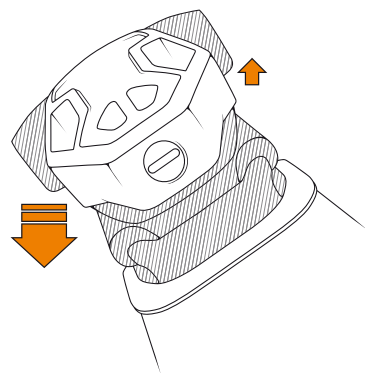

1 **More Power** directed to the ski for highly precise, less fatiguing turns (tilt stability).

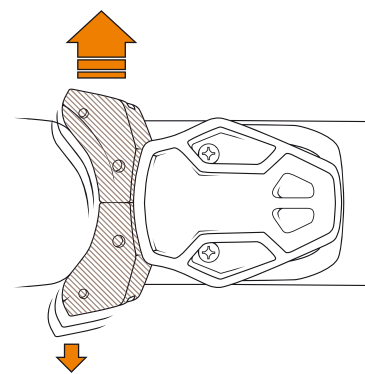

2 **Faster Re-Centering** and increased horizontal stability for more exact ski steering and better performance throughout the day, widest-possible screw placement for precise big mountain ski performance.

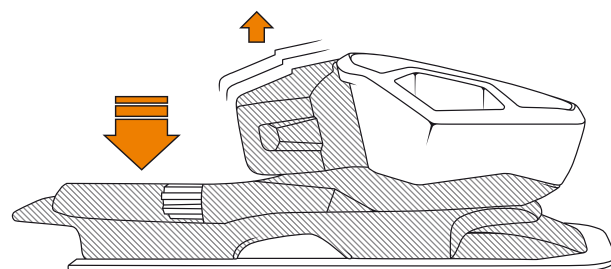

3 **More Vertical Tolerance** for accommodating various sole thicknesses (and a little muck, too), as well as precise ski control.

We're not bragging, we're just sayin' that these bindings out-ski our competition and take binding performance to the next level for the next generation of skiers.

BINDING TECHNOLOGY:

PowerRail Technology

The performance binding that meets the demands of ambitious skiers. Welcome to the fast lane in binding technology evolution: PowerRail - successor of Railflex System II.

- Easy Mounting & Adjusting
- Modular System
- Ideal for Retail, Demo and Rental
- Maximum Flexibility

HOW IT WORKS

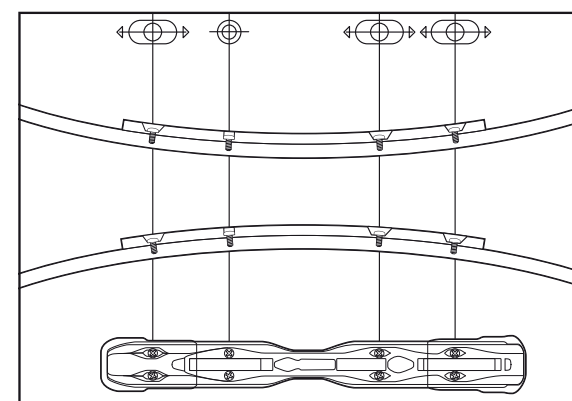
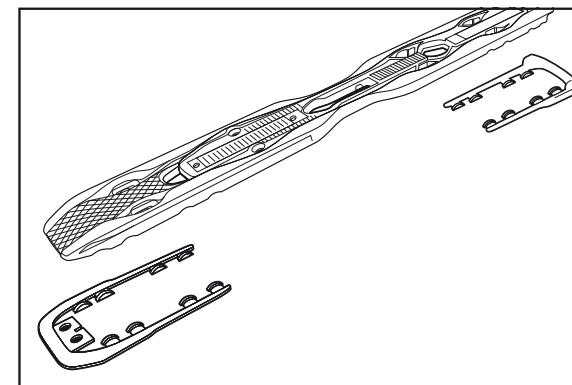
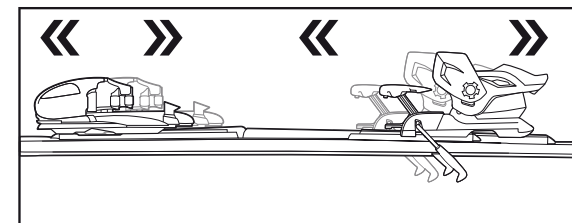
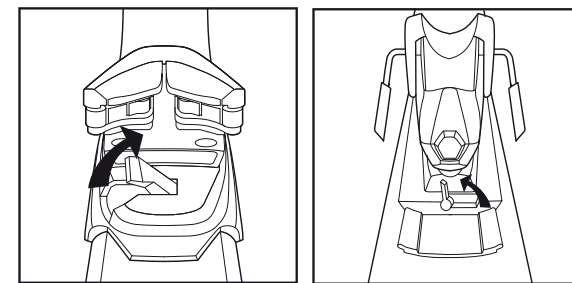

FEATURES

NO DRILLING OR SCREWING. JUST SLIDING.

- [1] Open toe lever and adjust.
- [2] Do the same with the heel.
- [3] Close the toe and heel lever. Done.

MODULAR SYSTEM

The PowerRail System was built modularly to match any rider's needs. Covering all segments with choices of Standard or Pro bases and dampeners in different widths for perfect ski fitting. PowerRail suits sole lengths between 260 and 380 mm.

NATURAL FLEX

To ensure unhindered natural flex the PowerRail base is mounted with one pair of fixed screws and three pairs of free gliding screws. This way the base smoothly adapts to the flex of the ski.

DOUBLE THE FLEX

The PowerRail Pro base is equipped with an additional freeflex band, linking the toothed areas at the toe and heel side of the base, allowing toe and heel pieces to glide unhindered. The double freeflex function ensures even more freedom, safety, and performance.

LONG-TERM PERFORMANCE

Each toe and heel guide can be exchanged or fitted separately, ensuring full functionality even after massive rental use.

BETTER POWER TRANSMISSION

PowerRail bases are 7% wider and 25% lower than Railflex II bases, directly improving power transmission from boot to edge.

BINDING TECHNOLOGY:

LiteRail Technology

THREE-STEP TOOL-FREE MOUNTING AND ADJUSTMENT

HOW IT WORKS

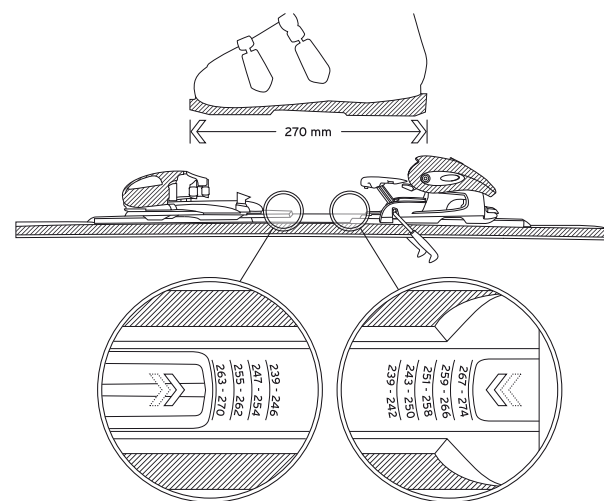

1 Determine the boot sole length. LiteRail covers boot sole lengths from 199-347 mm.

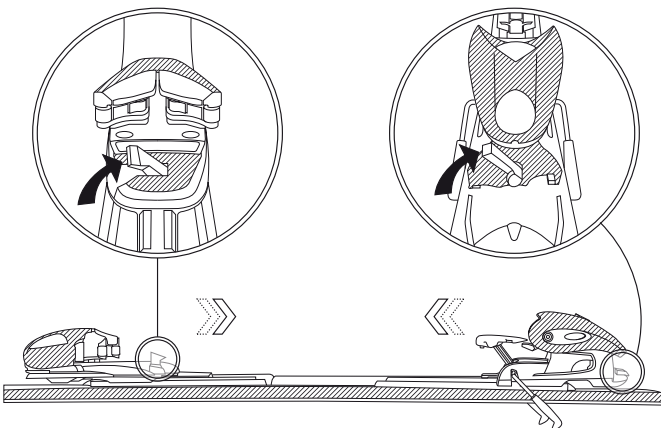

2 Open toe lever, slide toe on the base and close lever at the appropriate position.

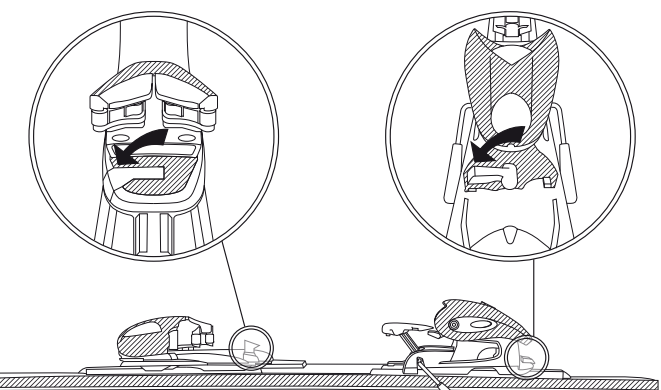

3 Hook brake into the heel, open the heel lever, slide heel on the base and close heel lever at appropriate position. OFF YOU GO.

BOOT TECHNOLOGY:

Raptor Technology

SPINEFLEX BUCKLES

Spineflex is a revolutionary buckle concept with a flexible element and a constant closure point for optimal foot wrapping without pressure points.

DOUBLE POWER BOOSTER VELCRO

The strap of the Double Power Booster Velcro works as a double pulley for better closure and a tighter wrapping on the cuff. The elastic Booster Strap allows more dynamical response of the boot. The result: more precise transmission and faster ski reaction. (Manufactured under license from Skimetrix Ltd.)

FEATURES

SPINEFLEX BUCKLES

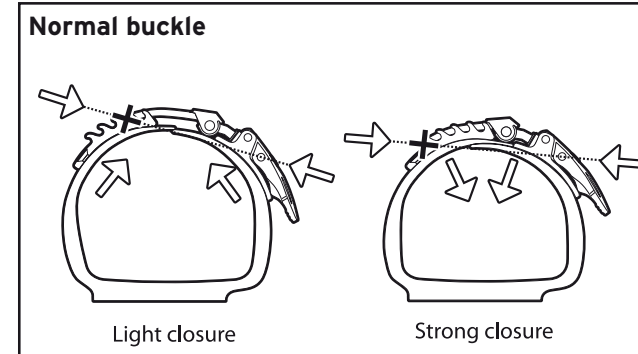

DOUBLE POWER BOOSTER VELCRO

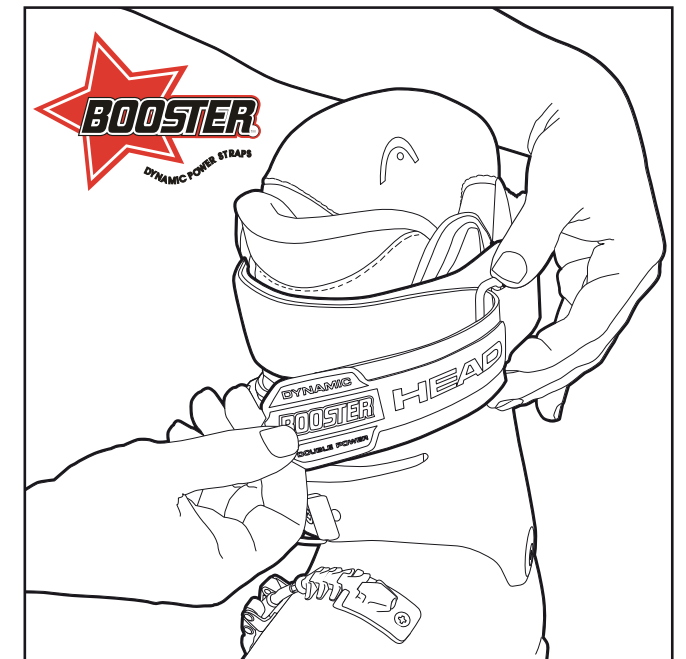

Protected under one or more of the following:
 European patent N. 1087676
 US patent N. 6.026.594
 Canadian patent N. 2.335.698
 Other patents pending.

BOOT TECHNOLOGY:

Adaptive Fit Technology

The **HEAD EDGE** series has a long-standing reputation for being one of the best fitting ski boots ever made. So really, when we developed the new **EDGE**, our intention was to keep all the comfort and come up with a way to increase precision. What our R&D brought back to us is nothing short of a revolution.

The **2011/2012 HEAD EDGE** is the first and only ski boot with two lasts: **HEAD Adaptive Fit Technology** lets you change the width of your boot from 104 mm to 102 mm with one turn of a screw.

This pushes the **EDGE onto a whole new level:**

Not only will it stay your best fitting, best selling boot in the comfort/performance segment, the 102 mm last adjustment will also put it on the feet of more ambitious, precision-oriented customers.

HOW IT WORKS

