

USA

2011 / 12 ALPINE RACE PROGRAM





Race Center Bible 11-12

Table of Contents

1. Table of Contents
2. Race Center List
3. Adult and Junior Race Skis
4. Adult and Junior Race Boots and Bindings
5. Sizing Chart
6. Dynastar Alpine Sponsorship Program Criteria 11-12
7. Lange Boot Alpine Sponsorship Program Criteria 11-12
8. Race Department Contacts
9. F.I.S. and USSA Equipment Rules 11-12
10. Race Product Compatibility
11. Binding and Boot Ramp Angles
12. I-Box WC / I-Box Composite Plate Binding Mounting Chart
13. MXF Binding Mounting Instructions
14. Boot Size Conversion Chart
15. Tuning Specs
16. Free-Hand Plate Mounting Instructions
17. Boot ISO Adult Standards
18. Race Stock Product Warranty



EASTERN

- D.C. -

Ski Center

Washington D.C.
202-966-4474
www.skicenter.com

- MAINE -

Happy Tunes

Kingfield, ME
207-235-8863

Jack Frost

Newry, ME
207-824-2519
www.jackfrostsports.com

Ski Depot

Jay, ME
207-897-5445
www.raceskis.com

- MINNESOTA -

Pierce Skate & Ski

Bloomington, MN
952-884-1900
www.pierceskateandski.com

- PENNSYLVANIA -

Guenther's Ski Haus

Honesdale, PA
570-253-5528
www.guenthersskihaus.com

- NEW HAMPSHIRE -

Stan and Dan Sports

North Conway, NH
603-359-6997
www.stananddansports.com

Bob Skinner's Ski & Sports

Mt. Sunapee, NH
603-763-2303
www.bobskinner.net

Artech

Enfield, NH
603-632-9152
www.artechski.com

Rodgers Ski & Sport

Lincoln, NH
603-745-8930
www.rodgersskiandsport.com

Ski Fanatics

Campton, NH
603-726-4327
www.skifanatics.net

- NEW YORK -

Snow Ski and Board

Rochester, NY
585-385-7669
snowskiandboards.com

The Ski Company

Rochester, NY
585-292-0580
www.skicompany.com

The Ski Company

Syracuse, NY
315-445-1890
www.skicompany.com

The Ski Company

Williamsville, NY
585-292-0580
www.skicompany.com

The Sports Page

Glens Falls, NY
518-792-1304
www.sportspageski.com

- VERMONT -

The Boot Pro

Ludlow, VT
802-228-2776
www.thebootpro.net

First Run Ski Shop

Stratton, VT
802-297-4321
www.stratton.com

Peak Performance Ski Shop

Killington, VT
802.422.9447
www.peakskishop.com

Pinnacle

Stowe, VT
802-253-7222
www.pinnacleskisports.com

Race Stock Sports

Waterbury, VT
802-578-3585
www.racestocksports.com

The Start House Ski & Bike

Woodstock, VT
802-457-3377
www.thestarthousevt.com

Totem Pole

Ludlow, VT
802-228-8447
www.totempoleskiandboard.com

- WISCONSIN -

Les Moise

Brookfield, WI
262-879-0800
Whitefish Bay, WI
414-964-5330
lesmoiseinc.com

WESTERN

- CALIFORNIA -

Footloose

Mammoth Lakes, CA
760-934-2400
www.footloosesports.com

Start Haus

Truckee, CA
530-582-5781
www.starthaus.com

- COLORADO -

Foothills Ski & Bike

Golden, CO
303-526-2036
foothillsskiandbike.com

- UTAH -

ALTA SKI SHOP

Alta, UT
801-799-2293
www.alta.com

- WASHINGTON -

WORLD CUP SKIER'S SERVICE

Bellevue, WA
425-644-8304
www.worldcupsc.com



SPEED OMEGLASS WC SLANT NOSE

ITEM # DA1AT01 (SIZES 155/165) / ITEM # DA1AT02 (SIZE 150 COMPOSITE)

SL **WOODTITANAL** **FIS** **SLANTNOSE TECHNOLOGY**
 RECOMMENDED BINDING: PX RACING 18 MFX ITEM #: DC9A001 DIN: 10-18
 PX RACING 15 MFX ITEM #: FC1A002 DIN: 8-15

	150	155	165
SIDECUT	116/65.5/100	117/65.5/101	120/65.5/102
RADIUS	11.4m	11.9m	13m
PLATE	I-BOX COMPOSITE	I-BOX WC	I-BOX WC



SPEED COURSE WC

ITEM # DA1DA01 (SIZES 175/182/185/191) / ITEM # DA1DA02 (SIZE 170 COMPOSITE)

GSS **WOODTITANAL** **FIS** **CASCADE TIP TECHNOLOGY** **EARLYRISE ROCKER**
 RECOMMENDED BINDING: PX RACING 18 MFX ITEM #: DC9A001 DIN: 10-18
 PX RACING 15 MFX ITEM #: FC1A002 DIN: 8-15

	170	175	182	185	191
SIDECUT	109/66/90	104/67.5/88.5	105/67.5/89	100.5/68/89	105.5/68/86.5
RADIUS	19m	23.6m	25m	27.3m	29m
PLATE	I-BOX COMPOSITE	I-BOX WC	I-BOX WC	I-BOX WC	I-BOX WC



TEAM OMEGLASS WC RACEFLEX JR

ITEM # DA1AU01 (SIZES 132/139/146/150) / ITEM # DA1AR01 (SIZE 125)

SL **SLANTNOSE TECHNOLOGY**
 MOUNTED WITH I-BOX COMPOSITE PLATE
 RECOMMENDED BINDING: PX TEAM ITEM #: FC1A009 DIN: 3-10

	125	132	139	146	150
SIDECUT	108/65/95	109/64/92	111/64/94	115/65/99	116/65.5/100
RADIUS	8.5m	9.5m	10.1m	10.3m	10.8m



TEAM COURSE WC RACEFLEX JR

ITEM # DA1DW01 (SIZES 135/140/145/150/155/160/165)

GSS
 MOUNTED WITH I-BOX COMPOSITE PLATE
 RECOMMENDED BINDING: PX TEAM ITEM #: FC1A009 DIN: 3-10

	135	140	145	150	155	160	165
SIDECUT	102/65.5/84	103/65.5/85	104/66/86	105/66/87	105/66/87	106/66/88	109/66/89
RADIUS	14.3m	14.9m	15.8m	16.5m	17.6m	18.3m	17.9m



TEAM COURSE

ITEM # DA1DW02 (SIZES 135/140/145/150/155/160)

GSS
 NO PLATE
 RECOMMENDED BINDING: PX TEAM ITEM #: FC1A009 DIN: 3-10

	135	140	145	150	155	160	165
SIDECUT	102/65.5/84	103/65.5/85	104/66/86	105/66/87	105/66/87	106/66/88	109/66/89
RADIUS	14.3m	14.9m	15.8m	16.5m	17.6m	18.3m	17.9m



TEAM PRO

ITEM # DA1AR02 (SIZES 125/130/135/140/145)

GSS
 NO PLATE
 RECOMMENDED BINDING: NOVA TEAM 7 MAXPLATE ITEM #: FC0A033 DIN: 2-7

	125	130	135	140	145
SIDECUT	108/65/95	110/65/95	112/65/95	112/65/95	115/64/95
RADIUS	8.5m	9.1m	9.6m	10.4m	10.6m

SPEED SKIS



SPEED WORLD CUP DH SPEED WORLD CUP SG

ITEM # DA9Y121 / DA9Y121 (SIZES 211/216)

ITEM # DA9Y117 / DA9Y119 (SIZES 201/208)

ITEM # DA8ZF01 (SIZES 186/195)

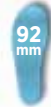

WORLD CUP R2006

ITEM # LB09200: ZA/ZA SOFT = FLEX 110
 ITEM # LB09210: ZA/ZA = FLEX 120
 ITEM # LB09220: ZB/ZB = FLEX 130
 ITEM # LB09230: ZC/ZC = FLEX 150
 SIZE: 22.5 - 28.5 mondo
 LAST: 92MM



RS 140

ITEM # LB01010

SIZE: 24.5 - 30.5 mondo
 LAST: 97mm
 FLEX: 140
 SHELL MATERIAL: POLYETHER



RS 110 S.C.

ITEM # LB01310

SIZE: 22.5 - 27.5 mondo
 LAST: 97mm
 FLEX: 110
 SHELL MATERIAL: POLYURETHANE
 SHORT CUFF



RS 90 S.C.

ITEM # LB15010

SIZE: 22.5 - 27.5 mondo
 LAST: 97mm
 FLEX: 90
 SHELL MATERIAL: POLYURETHANE
 SHORT CUFF



RACE 70 TEAM

ITEM # LB15030

SIZE: 3.5 - 9.5 US
 LAST: 98mm
 FLEX: 70
 SHELL MATERIAL: POLYURETHANE



RSJ 65

ITEM # LB15120

SIZE: 22.5 - 27.5 mondo
 LAST: 98mm
 FLEX: 65
 SHELL MATERIAL: POLYURETHANE



RSJ 60

ITEM # LB15140

SIZE: 19.5* - 26.5 mondo
 FLEX: 60
 SHELL MATERIAL: POLYURETHANE

*JUNIOR SOLE = SIZES 19.5-21.5



RSJ 50

ITEM # LB15170

SIZE: 17.5-21.5* mondo
 FLEX: 50
 SHELL MATERIAL: POLYURETHANE

*JUNIOR SOLE = SIZES 19.5-21.5



PX RACING 18 MAXFLEX ITEM # DC19A001

DIN: 10-18
 TOE: SINGLE PIVOT
 BRAKE: 80mm
 HEEL: PX



PX RACING 15 MAXFLEX ITEM # FC1A002

DIN: 8-15
 TOE: SINGLE PIVOT
 BRAKE: 80mm
 HEEL: PX



PX RACING 14 ITEM # FC1A003

DIN: 5-14
 TOE: DUAL ACTION
 BRAKE: 64-80mm
 HEEL: PX



PX RACING 12 ITEM # FC1A005

DIN: 3.5-12
 TOE: DUAL ACTION
 BRAKE: 80mm
 HEEL: PX



PX TEAM ITEM # FC1A009

DIN: 3-10
 TOE: SINGLE PIVOT



BRAKE: 80mm
 HEEL: PX



NOVA TEAM 7 MAXPLATE ITEM # FCOA033

DIN: 2-7
 TOE: SINGLE PIVOT

BRAKE: 73mm
 HEEL: NOVA



NOVA TEAM 7 ITEM # FCOA034

DIN: 2-7
 TOE: SINGLE PIVOT



BRAKE: 73mm
 HEEL: NOVA



RACE G-SG SR ITEM # DD01020

7075 ALLOY DH CONE BASKET CARBIDE TIP SIZES: 115-140cm

RACE G-SG JR ITEM # DD03000

7075 ALLOY DH CONE BASKET CARBIDE TIP SIZES: 90-115cm



RACE S SR ITEM # DD01040

7075 ALLOY COURSE 51 BASKET CARBIDE TIP SIZES: 115-140cm

RACE S JR ITEM # DD03010

7075 ALLOY COURSE 51 BASKET CARBIDE TIP SIZES: 90-115cm



SPEED TEAM ITEM # DD16000

7075 ALLOY PERFORMANCE BASKET STEEL TIP SIZES: 90-115cm



GENERAL OBSERVATIONS

Ski selection, both model and length, always will be a very personal and to a large degree a very subjective decision. The following chart shows some of the common trends we noticed as a result of our ongoing testing, which should be taken into consideration when making model and length decisions. Optimal ski length is determined by the following order: ability, weight and strength. Dynastar's Race Department hopes you will find this information useful and wishes you an excellent winter of racing. Good luck at the races!

JUNIOR 5 & 6 ages 6 to 10 years old (born 2001 or younger)

athlete weight	recommended Multi Event ski model & size for J6		recommended Multi Event ski model & size for J5		recommended binding
45 - 50 lbs	Team Comp	110cm	Team Comp	110	Team 4
50 - 55 lbs		120cm		120	
55 - 60 lbs		130cm	125	Nova Team 7 Maxplate	
60 - 70 lbs			130		
70 - 80 lbs			135		
80 - 90 lbs		140cm	140		
100 - 110 lbs			145		

***Lighter and/or less aggressive athletes should error on the shorter size
 ***Lighter and/or less aggressive J5 racers should opt for Team Comp model

JUNIOR 4 ages 11 to 12 years old (born 2000 & 1999)

athlete weight	recommended GS model	recommended GS size	recommended SL model	recommended SL size	recommended model and size for use as Multi Event ski	recommended binding
70 - 80 lbs	Team Course WC w/ I-Box Composite Plate	135cm	Team Omeglass WC w/ I-Box Composite Plate	125cm	Team Course	Nova Team 7 Maxplate
80 - 90 lbs		140cm		132cm		
90 - 100 lbs		145cm		139cm		
100 - 110 lbs		150cm		146cm	PX Team	
110 - 120 lbs		155cm				135cm
120 + lbs		165cm				140cm
						145cm

***Lighter and/or less aggressive athletes should error on the shorter size

JUNIOR 3 ages 13 to 14 years old (born 1998 & 1997)

athlete weight	recommended GS model	recommended GS size	recommended SL model	recommended SL size	recommended binding
90 - 100 lbs	Team Course WC w/ I-Box Composite Plate	155cm	Team Omeglass WC w/ I-Box Composite Plate	132cm	PX Team
100 - 110 lbs		160cm		139cm	
110 - 120 lbs		165cm		146cm	
120 - 130 lbs	Speed Course WC	170cm	Speed Omeglass WC w/ I-Box Composite Plate	150cm	PX Racing 12
130 - 140 lbs	Speed Course WC w/ I-Box WC Plate	175cm			
140 - 150 lbs		182cm			
150 + lbs			Speed Omeglass WC		PX Racing 15 MXF

***Lighter and/or less aggressive athletes should error on the shorter size and use the Composite Plate when applicable

JUNIOR 1 / 2, Seniors, Masters -WOMEN- ages 15 & up (born 1996 and older)

athlete weight	High School / USSA RECOMMENDATIONS					F.I.S. RECOMMENDATIONS				
	recommended GS model	recommended GS size	recommended SL model	recommended SL size	recommended binding	recommended GS model	recommended GS size	recommended SL model	recommended SL size	recommended binding
100 - 110 lbs	Speed Course WC	170cm	Speed Omeglass WC w/ I-Box Composite Plate	150cm	PX Racing 12	Speed Course WC w/ I-Box WC Plate	175cm	Speed Omeglass WC w/ I-Box WC Plate	155cm FIS Rules	PX Racing 15 MXF
110 - 120 lbs										
120 - 130 lbs	Speed Course WC w/ I-Box WC Plate	182cm					Speed Omeglass WC w/ I-Box WC Plate			
130 - 140 lbs										
140 - 150 lbs			185cm	165cm	165cm	165cm FIS rules	PX Racing 18 MXF			
150 - 160 lbs										
160 - 170 lbs										
170 + lbs										

***Lighter and/or less aggressive athletes should error on the shorter size and use the Composite Plate when applicable

JUNIOR 1 / 2, Seniors, Masters -MEN- ages 15 & up (born 1996 and older)

athlete weight	High School / USSA RECOMMENDATIONS					F.I.S. RECOMMENDATIONS				
	recommended GS model	recommended GS size	recommended SL model	recommended SL size	recommended binding	recommended GS model	recommended GS size	recommended SL model	recommended SL size	recommended binding
100 - 110 lbs	Speed Course WC	170cm	Speed Omeglass WC w/ I-Box Composite	150cm	PX Racing 12	Speed Course WC w/ I-Box WC Plate	185cm	Speed Omeglass WC w/ I-Box WC Plate	165cm FIS rules	PX Racing 15 MXF
110 - 120 lbs										
120 - 130 lbs	Speed Course WC w/ I-Box WC Plate	182cm								
130 - 140 lbs										
140 - 150 lbs			185cm	165cm	165cm	165cm FIS rules	PX Racing 18 MXF			
150 - 160 lbs										
160 - 170 lbs										
170 + lbs										

NOTE All recommendations comply F.I.S./USSA regulations for radius, minimum length, standheight

2011 / 12 ALPINE RACE SPONSORSHIP PROGRAM



Dynastar/Lange offers an expanded race sponsorship program that allows more skiers to race at a more affordable price than ever before. Our deep-rooted history in ski racing has produced numerous World Championship, World Cup, Olympic and junior program victories worldwide. We've created four sponsorship levels to help ski racers at all levels.

SPONSORSHIP CRITERIA GUIDELINES

YEAR OF BIRTH	PLATINUM	GOLD	SILVER	BRONZE
1998	N/A	Rep Discretion	Top-5 at JO's	Top-15 at JO's
1997	N/A	Top 5 at JO's	Top-15 at JO's	JO Participation
1996	Rep Discretion	Top 3 at JO's	Top-15 at JO's	JO Participation
1995	(1) Top 5 - M (1) Top 3 - W	(1) Top 15 - M (1) Top 10 - W	(1) Top 30 - M (1) Top 30 - W	(1) Top 50 - M (1) Top 50 - W
1994	(1) Top 5 - M (1) Top 3 - W	(1) Top 15 - M (1) Top 10 - W	(1) Top 30 - M (1) Top 30 - W	(1) Top 50 - M (1) Top 50 - W
1993	(2) Top 5 - M (2) Top 3 - W	(1) Top 10 - M (1) Top 10 - W	(1) Top 30 - M (1) Top 30 - W	(1) Top 50 - M (1) Top 50 - W
1992	(1) Top 3 - M (2) Top 3 - W	(2) Top 10 - M (2) Top 10 - W	(1) Top 30 - M (1) Top 30 - W	(1) Top 50 - M (1) Top 50 - W
Non-Junior	NCAA Champion NorAm/Europa Cup Competitor Rep Discretion	NCAA All-American Rep Discretion	NCAA/USCSA Carnival Member Rep Discretion	NCAA/USCSA Team Member

* All Sponsorship levels are based on national age ranking

QUALIFICATION CRITERIA

The designated criteria of this program must be met before submitting the order form. Limited spots are available for Platinum, Gold, and Silver. Any racer accepted in to this program must race and train exclusively on Dynastar skis, Lange boots, and Look bindings. Dynastar/Lange athletes are expected to be a positive ambassador to the company and the sport. Any racer in the program who is on the podium must represent the company by having Dynastar skis on the podium.

Platinum and Gold have limited sponsorship space and are filled on a first-come basis.

ALL RACE STOCK ORDERS NEED DYNASTAR REP'S PRE-APPROVAL

- Full time racers with valid USSA and F.I.S licenses
- Qualified for J3 Junior Olympics, J2 Nationals or US Nationals
- Qualified for JIV Regional Championships
- Dynastar's rep's discretion
- Nothing will be shipped until payment has cleared. No exceptions.
- All sales are final.
- Sales are based on availability of inventory
- Dynastar reserves the right to substitute product of equal or greater value

SPONSORSHIP PACKAGES

LIMITED QUANTITIES OF PLATINUM AND GOLD PACKAGES AVAILABLE.

A

2 PAIR GS
2 PAIR SL
1 PAIR BOOTS

MSRP = \$5000

PRICING
PLATINUM = \$0
GOLD = \$1800
SILVER = \$2600
BRONZE = \$3600

B

2 PAIR GS
2 PAIR SL
1 PAIR SG
1 PAIR BOOTS

MSRP = \$6250

PRICING
PLATINUM = \$600
GOLD = \$2450
SILVER = \$3100
BRONZE = \$4500

C

2 PAIR GS
2 PAIR SL
1 PAIR SG
1 PAIR DH
1 PAIR BOOTS

MSRP = \$7500

PRICING
PLATINUM = \$1200
GOLD = \$3150
SILVER = \$3600
BRONZE = \$5400

**PX RACING 18
MAXFLEX
BINDING**

MSRP = \$475

PRICING
PLATINUM = \$120
GOLD = \$180
SILVER = \$260
BRONZE = \$320

**PX RACING 15
MAXFLEX
BINDING**

MSRP = \$375

PRICING
PLATINUM = \$90
GOLD = \$135
SILVER = \$210
BRONZE = \$250

RACE DEPARTMENT CONTACT

BEN BURNS
Race Program
Coordinator / USA

cell phone:
801-243-6594
office phone:
435-252-3360
fax:
435-252-3303
e-mail:
ben.burns@rossignol.com

Lange is *the* choice of champions. There is no disputing that Lange is by far the most victorious boot in ski racing history. Lange has propelled endless racers to the most prestigious of accomplishments -- from junior to World Cup ranks. Lange offers racers a boot- only sponsorship that allows more racers to reach the next level, regardless of their ski brand affiliation. We have created 4 boot only sponsorship levels to help junior racers reach their goals.

SPONSORSHIP CRITERIA GUIDELINES

YEAR OF BIRTH	PLATINUM	GOLD	SILVER	BRONZE
1998	N/A	Rep Discretion	Top-5 at JO's	Top-15 at JO's
1997	N/A	Top 5 at JO's	Top-15 at JO's	JO Participation
1996	Rep Discretion	Top 3 at JO's	Top-15 at JO's	JO Participation
1995	(1) Top 5 - M (1) Top 3 - W	(1) Top 15 - M (1) Top 10 - W	(1) Top 30 - M (1) Top 30 - W	(1) Top 50 - M (1) Top 50 - W
1994	(1) Top 5 - M (1) Top 3 - W	(1) Top 15 - M (1) Top 10 - W	(1) Top 30 - M (1) Top 30 - W	(1) Top 50 - M (1) Top 50 - W
1993	(2) Top 5 - M (2) Top 3 - W	(1) Top 10 - M (1) Top 10 - W	(1) Top 30 - M (1) Top 30 - W	(1) Top 50 - M (1) Top 50 - W
1992	(1) Top 3 - M (2) Top 3 - W	(2) Top 10 - M (2) Top 10 - W	(1) Top 30 - M (1) Top 30 - W	(1) Top 50 - M (1) Top 50 - W
Non-Junior	NCAA Champion NorAm/Europa Cup Competitor Rep Discretion	NCAA All-American Rep Discretion	NCAA/USCSA Carnival Member Rep Discretion	NCAA/USCSA Team Member

* All Sponsorship levels are based on national age ranking

QUALIFICATION CRITERIA

The designated criteria of this program must be met before submitting the order form. Limited spots are available for Platinum, Gold, and Silver. Any racer accepted in to this program must race and train exclusively on Lange ski boots. Lange athletes are expected to be a positive ambassador to the company and the sport. Any racer in the program who is on the podium must represent the company by having Lange ski boots on the podium.

Platinum and Gold have limited sponsorship space and are filled on a first-come basis.

ALL RACE STOCK ORDERS NEED

LANGE REP'S PRE-APPROVAL

- Full time racers with valid USSA and F.I.S licenses
- Qualified for J3 Junior Olympics, J2 Nationals or US Nationals
- Qualified for JIV Regional Championships
- Lange's rep's discretion
- Nothing will be shipped until payment has cleared. No exceptions.
- All sales are final.
- Sales are based on availability of inventory
- Lange reserves the right to substitute product of equal or greater value

SPONSORSHIP PACKAGE

LIMITED QUANTITIES OF PLATINUM, GOLD AND SILVER PACKAGES AVAILABLE.

1 PAIR BOOTS

MSRP = \$980

PRICING

PLATINUM = \$0

GOLD = \$275

SILVER = \$538

BRONZE = \$599.95



RACE DEPARTMENT CONTACT

BEN BURNS

Race Program Coordinator / USA

cell phone: 801-243-6594

office phone: 435-252-3360 / fax: 435-252-3303

e-mail: ben.burns@rossignol.com





RACE DEPARTMENT – CONTACTS

National Race Coordinator:	Ben Burns (435) 252-3360 office (801) 243-6594 ben.burns@rossignol.com	Dynastar Lange The Mountain Center 1413 Center Dr. PO Box 981060 Park City, UT 84098
<u>Assisted by:</u>		
Far West Division:	Northern Cal, Northern Nev. Andy Miller (530) 263 8635	andy.miller@dynastar.net
Far West Race Service:	Mammoth, Tahoe Mike Braun (661) 857-9346	mike.braun@rossignol.com
PNSA Division:	Oregon, Washington, Alaska Sean Vill (206)953 7407	sean.vill@dynastar.net
Northern Division: Intermountain Division:	Montana Utah, Wyoming, Southern Idaho Dave Marsland (801) 557 9798	david.marsland@dynastar.net
Rocky Mountain Division:	Colorado Ed Green (970) 376 2187	ed.green@dynastar.net
Central Division:	Illinois, Michigan, Minnesota, Wisconsin Chip Camillo (608) 770 6374	chip.camillo@dynastar.net
Eastern Division:	Maine, Eastern Massachusetts, New Hampshire, Rhode Island Chris Clapp (603) 491 4168	chris.clapp@dynastar.net
Eastern Division:	Vermont, Connecticut, Western Massachusetts Bill Levins (802) 249 8772	bill.levins@dynastar.net



F.I.S. & USSA Equipment Rules 2011/2012



	World Cup & Continental Cup (Nor-Am, Europa Cup Only)	World Cup & Continental Cup (Nor-Am, Europa Cup Only)	FIS/ENL and USSA 15 yrs old +	FIS/ENL and USSA 15 yrs old +	Children 2 FIS 13-14 yr old international race only	Children 1 FIS 11-12 yr old international race only	Junior 3 USSA 13 - 14 yr old	Junior 4 USSA 11 - 12 yr old	USSA/FIS Masters	USSA/FIS Masters
	Men	Women	Men	Women	Boys & Girls	Boys & Girls	Boys & Girls	Boys & Girls	Men	Women

Minimum Ski Length

DH	215 cm	210 cm	210 cm USSA may use SG skis for DH	205 cm USSA may use SG skis for DH	no rule	no rule	no rule	no rule	Only skis designated for DH or SG allowed	
SG	205 cm	200 cm	200 cm	195 cm	175 cm	no rule	no rule	no rule	185 cm GS skis allowed	180 cm GS skis allowed
GS	185 cm	180 cm	180 cm	175 cm	130 cm	130 cm	no rule	no rule	See Note Below	See Note Below
SL	165 cm	155 cm	165 cm 10cm tolerance for J2 men	155 cm	130 cm	130 cm	no rule	no rule	See Note Below	See Note Below

Minimum Ski Radius

DH	45 m	45 m	45 m USSA may use SG skis for DH	45 m USSA may use SG skis for DH	no rule	no rule	no rule	no rule	See Note Below	See Note Below
SG	33 m	33 m	33 m	33 m	27 m	no rule	no rule	no rule	See Note Below	See Note Below
GS	27 m	23 m	FIS 27 m USSA 21 m	FIS 23 m USSA 21 m	17 m	14 m	no rule	no rule	See Note Below	See Note Below
SL	no rule	no rule	no rule	no rule	no rule	no rule	no rule	no rule	See Note Below	See Note Below

Minimum Ski Waist Width

DH	67 mm	67 mm	FIS 67 mm USSA 60 mm	FIS 67 mm USSA 60 mm	no rule	no rule	no rule	no rule	See Note Below	See Note Below
SG	65 mm	65 mm	FIS 65 mm USSA 60 mm	FIS 65 mm USSA 60 mm	no rule	no rule	no rule	no rule	See Note Below	See Note Below
GS	65 mm	65 mm	FIS 65 mm USSA 60 mm	FIS 65 mm USSA 60 mm	no rule	no rule	no rule	no rule	See Note Below	See Note Below
SL	63 mm	63 mm	FIS 63 mm USSA 60 mm	FIS 63 mm USSA 60 mm	no rule	no rule	no rule	no rule	See Note Below	See Note Below

Maximum Binding Stack Height

Measurement includes ski + plate + binding

50 mm	50 mm	50 mm	50 mm	50 mm	50 mm	50 mm	50 mm	50 mm	50 mm	50 mm
-------	-------	-------	-------	-------	-------	-------	-------	-------	-------	-------

Maximum Boot Height

Measurement from sole to top of foot bed

43 mm	43 mm	43 mm	43 mm	43 mm	43 mm	43 mm	43 mm	43 mm	45 mm	45 mm
-------	-------	-------	-------	-------	-------	-------	-------	-------	-------	-------

* For FIS Masters Competition, equipment rules are recommendations with the following exceptions: in SG races, the ski length may not be less than 185 cm for men and 180 cm for women:(GS skis may be used for SG). For the FIS recommendations for ski length, ski radius and waist width see the current FIS Specifications for Competition Equipment.

* USSA Masters rules conform to the FIS Masters equipment rules. USSA recommends that competitors in USSA masters events compete on equipment designed for the particular discipline (DH, SL, GS, SG), but does not make any recommendations in regard to ski length.



Race Product Compatibility 11-12

Plate/ Binding

item #	Ski/plate	Plate	Binding	Boot sole range
DA9Y120	Speed World Cup DH (215/211)	I-Box WC Speed	PX Racing 18, 15, 12	264 - 341mm
DA9Y117	Speed World Cup SG (209/201)	I-Box WC Speed	PX Racing 18, 15, 12	264 - 341mm
DA8ZJ01	Speed World Cup DH 09/10 model (215/211)	I-Box WC Speed	PX Racing 18, 15, 12	264 - 341mm
DA8ZI01	Speed World Cup SG 09/10 model (209/201)	I-Box WC Speed	PX Racing 18, 15, 13	264 - 341mm
DA1DA01	Speed Course World Cup GS (191/185/182/175)	I-Box WC Tech	PX Racing 18, 15, 12	264 - 341mm
DA1AT01	Speed Omeglass World Cup SL (165/155)	I-Box WC Tech	PX Racing 18, 15, 12	264 - 341mm
DA1DW01	Team Course World Cup GS (165/160/155/150/145/141)	I-Box Composite	PX Racing 12, PX Team, Nova *no MXF	PX Racing 12 264-341mm PX Team 246-365mm Nova 246-365mm
DA1AU01	Team Omeglass World Cup SL (150/146/139/132)	I-Box Composite	PX Racing 12, PX Team, Nova *no MXF	PX Racing 12 264-341mm PX Team 246-365mm Nova 246-365mm
DA1DW02	Team Course (160/155/150/145/140/135)	no plate	Team *no MXF	
DA1AR02	Team Pro (145/140/135/130/125)	I-Box Composite	PX Racing 12, PX Team, Nova, *no MXF	

FIS Racing Standheight (measurement is = Ski + Plate + Binding)

item #	Ski/plate	Lifter	FIS Rule 11-12
<u>J2 and older (15yrs +)</u>			
DA9Y120	Speed World Cup DH (215/211)	possible but not recommended	50mm
DA9Y117	Speed World Cup SG (209/201)	possible but not recommended	50mm
DA8ZJ01	Speed World Cup DH 09/10 model (215/211)	possible but not recommended	50mm
DA8ZI01	Speed World Cup SG 09/10 model (209/201)	possible but not recommended	50mm
DA1DA01	Speed Course World Cup GS (191/185/182/175)	4mm lifter	50mm
DA1AT01	Speed Omeglass World Cup SL (165/155)	4mm lifter	50mm

J3 and younger (14yrs and younger)

DA1DW01	Team Course World Cup GS (165/160/155/150/145/141)	possible but not recommended	50mm
DA1AU01	Team Omeglass World Cup SL (150/146/139/132)	possible but not recommended	50mm
DA1DW02	Team Course (160/155/150/145/140/135)	up to 14mm can be added	50mm
DA1AR02	Team Pro (145/140/135/130/125)	up to 14mm can be added	50mm

FIS Racing Boot Height

item #	Boot model	Additional Lifter	Actual Height size 8 w/ stock footbed	Stock Footbed Thickness	FIS Rule 10-11
LB09230-9200	R2006	3mm	40.0mm	3.9mm	43mm
LB01030	RS 130 / 110	3mm	39.0mm	3.9mm	43mm
LB01310	RS 110 Short Cuff	3mm	39.0mm	3.9mm	43mm
LB15010	RS 90 Short Cuff	3mm	39.0mm	3.9mm	43mm
LB15030	Race Team 70	3mm	39.0mm	3.9mm	43mm

*Caution this is a guideline, Footbed thickness will effect overall height
 **3mm maybe added if grinding sole for canting



Race Product Compatibility 11-12

Binding Bootsole Norms

item #	Description	Toe Norm
DC9A001	PX Racing 18, PX Racing 15	Adult only
FC1A003	PX Racing 14	Adult only
FC1A005	PX Racing 12	Adult only
FC1A009	PX Team	Adult Only
FC0A033	Nova Team 7 Max	Children & Adult
FC0A034	Nova Team 7	Children & Adult
FC0A039	Team 4 RL	Children & Adult
FC0A043	Team 2 RL	Children & Adult

Bootsole Norms

item #	Boot model	sizes available	Adult DIN	Child DIN
LB09230-9200	R2006	22.5 - 28.5	22.5 - 28.5	
LB01030	RS 130 / 110	24.5 - 30.5	24.5 - 30.5	
LB01310	RS 110 Short Cuff	22.5 - 27.5	22.5 - 27.5	
LB15010	RS 90 Short Cuff	22.5 - 27.6	3.5 - 9.5	
LB15030	Race Team 70	3.5-9.5	23.5 - 26.5	
LB15120	RSJ 65	22.5-27.5	22.5-26.5	
LB1760	RSJ 60	19.5-26.5	22.5-26.5	17.5 - 21.5
LB15170	RSJ 50	17.5-21.5		17.5 - 21.6

Mounting Templates

item #	Description	Bindings	Ski Width	Ski Width	Ski Width
			Rubber in	Rubber out	No Rubber
FC0F001	Adult Mounting Template	PX Racing 18, 15, 14, 12, PX Team, Nova	80	120	130
FC8NF01	I-Box Mounting Template	Plate for PX Racing 18, 15, 14, 1	91		
FC0F018	Junior Mounting Template	Team	77	93	96



BINDING & BOOT RAMP ANGLES

	Toe Height in mm	Heel Height in mm	Heel-Toe Difference in mm	Size 8 308 Ramp in degrees	Size 4 276 Ramp in degrees
PX Racing 18 & 15 Maxflex	13.50	17.00	3.50	0.7	0.7
PX Racing 14 & 12	14.00	17.00	3.00	0.6	0.6
PX Team	14.50	19.50	5.00	0.9	1.0
Nova Team 7 Maxplate	16.00	22.00	6.00	1.1	1.2
Nova Team 7	9.00	18.00	9.00	1.7	1.9

R2006	2.2 to 2.5	degrees, depending on size	} Small size boots more ramp Large size boots less ramp
RS 130 & 110	3.5 to 4.0	degrees, depending on size	
RS 130 & 110	3.5 to 4.0	degrees, depending on size	
RS 110 & 90 S.C. (short cuff)	3.5 to 4.0	degrees, depending on size	
Race Team 70	3.6 to 4.0	degrees, depending on size	

Calculation: $\arctan(q) = \text{opposite} / \text{adjacent} *$
 Opposite = Difference between Binding heel height and toe height in mm
 Adjacent = Athlete's bootsole length in mm

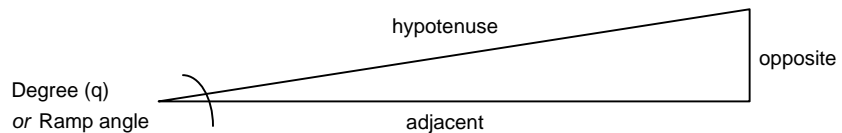

Equation: $[(\arctan(q) = \text{opposite} / \text{adjacent}) * (180 / 3.14159)]$

*the result of the above calculation is in radians and needs to be converted to degrees by multiplying by (180/Pi) Pi= 3.14159

I-BOX WC / I-BOX / RACE FLEX WC PLATE BINDING MOUNTING

FOR DYNASTAR PX RACING MAXFLEX AND
ROSSIGNOL AXIAL² WORLD CUP MFX



Quick Reference Chart for Binding Placement

<i>sole length range</i>	<i>toe piece mounting</i>	<i>heel piece mounting</i>
264-280mm		
281-294mm		
295-308mm		
309-325mm		
326-341mm		

LOOK PX RACING MAXFLEX ROSSIGNOL AXIAL² WORLD CUP MFX

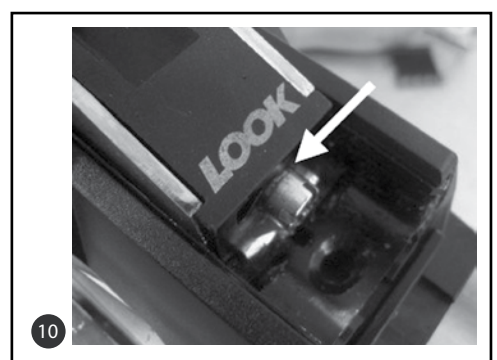
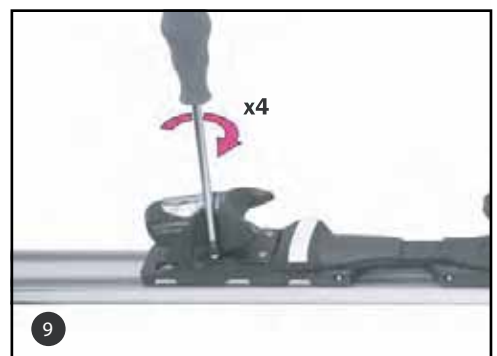
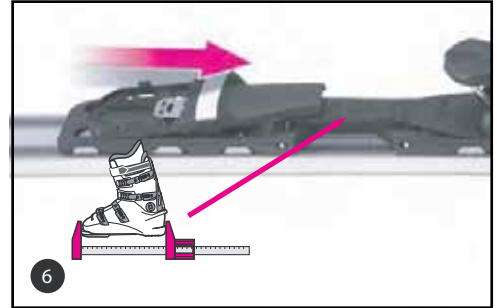
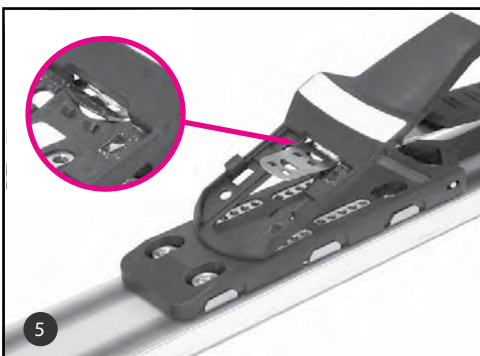
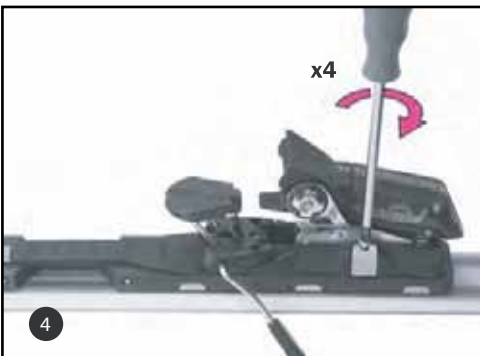
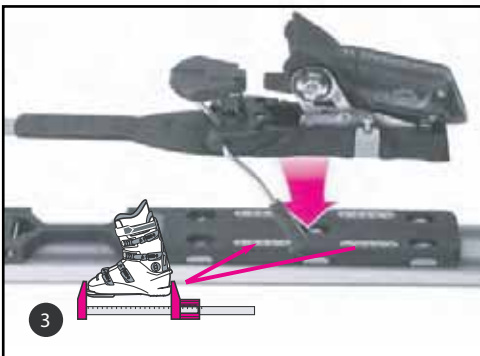

1. Insert cover at 30° angle to heel.
2. Push down toward metal bar to lock center plate in place.
3. Align heel with appropriate boot sole range. See chart on Page 17.
4. Tighten screws and ensure heel piece is flush with ski or plate.
5. While lifting the front of the metal bar, insert AFD plate.
6. Slide AFD plate to the appropriate boot sole range.
7. AFD plate must match boot sole marking.
8. Position AFD by using the forward pressure screw at heel. Once the holes from the AFD align with the proper holes on the plate, connect the toe piece to AFD. See chart on Page 17.
9. Tighten the screws with 5Nm of torque and ensure toe piece is flush with ski or plate.
10. To check the correct forward pressure, the mark on the screw should be lined up with the black plastic piece as shown below.
11. Go to page 35 for adjustment settings.

Alpine Boot 11/12



Lange Boot Sole Sizes & Lengths in millimeters (mm)

European Adult										37.0	38.0	39.0	39.5	40.5	42.0	43.0	44.5	46.0	46.5	48.0	49.5	
Mondo			15.5	16.5	17.5	18.5	19.5	20.5	21.5	22.5	23.5	24.0	24.5	25.5	26.5	27.5	28.5	29.5	30.5	31.5	32.5	
Men - US Sizing								2.5	3.5	4.5	5.5	6.0	6.5	7.5	8.5	9.5	10.5	11.5	12.5	13.5	14.5	
Women - US Sizing										5.5	6.5	7.0	7.5	8.5	9.5	10.5						
Kids - US Sizing			9.5	11	12	13	14	1.5	2.5	3.5	4.5	5.0	5.5									
<i>Model</i>	<i>shell width</i>	<i>size type</i>																				
R2006 World Cup	92mm	Mondo								266	276		284	293	303	314	320					
RS	97mm	Mondo								266	276		286	296	306	316	326	336				
RX / RS Wide	100mm	Mondo								276	276		286	296	306	316	326	336	346			
RS S.C. 110/ 90 (Short Cuff)	97mm	Mondo								276	276		286	296	306	316						
Race Team 70	98mm	US-mens							266	276	284		292	300	308	317						
RSJ 65	junior	Mondo								268	275		286	298	308							
RSJ 60	junior	Mondo					240	249	259	268	275		286	298	308							
RSJ 50	junior	Mondo			231*	231*	240*	249*	259*													

* Childrens boot sole norm



RACE DEPARTMENT TUNING SPECIFICATIONS

WORLD CUP TUNING SPECS

<i>event / ski</i>	<i>base degree</i>	<i>side edge degree</i>	<i>notes</i>
DH	1	3	sharp tip to tail with light dulling at tip and tail by athlete preference
SG	1	3	sharp tip to tail with light dulling at tip and tail by athlete preference
GS	.7 or 1	3	sharp tip to tail no dulling
SL	.5 or 1	3 or 4	sharp tip to tail no dulling

Note: these are general world cup tuning guide lines. Using different base and side bevels can drastically change the performance of a ski, this is based on athlete preference. Large side edge bevels will reduce ski life considerably.

RECOMMENDED JUNIOR RACER TUNING SPECS

<i>event / ski</i>	<i>base degree</i>	<i>side edge degree</i>	<i>notes</i>
DH	1	2	sharp tip to tail with light dulling roughly 2" to 4 " from contact point of tip and tail
SG	1	2	sharp tip to tail with light dulling roughly 1" to 3 " from contact point of tip and tail
GS	1	2	sharp tip to tail no dulling
SL	.7 or 1	2	sharp tip to tail no dulling
JUNIOR	1	1 or 2	sharp tip to tail no dulling as a general rule



Free-Hand Plate Mounting Guidelines

1. Assembly plate and position plate center on ski center mark



2. Align the plate side-to-side on the ski. This can be done visually and/or measured by using a caliper or tape measure
3. Secure the plate with at least 2 clamps



4. On the I-Box plate you will notice 4 holes that are not floating, and 5 holes that have floating slots.
5. The 5 holes that require floating inserts, position the floating insert in center of the floating slot.



6. Using a regular 7/32-inch drill bit. Lightly tap the drill bit through all the inserts, making a small mark (dimple) on the ski. Do not use any pressure

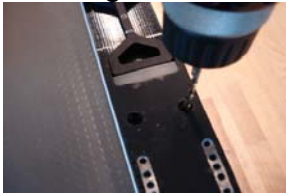

7. Remove the plate from the ski; you will have center drill marks (dimples) on the ski were you need to drill with the proper ski drill bit



8. Drill all the dimples with a 4.1x9.5 ski drill bit
9. Mount the plate
10. Mount binding in the correct holes for the boot sole length

Adult Boot Sole ISO standards

Dimensions in millimetres

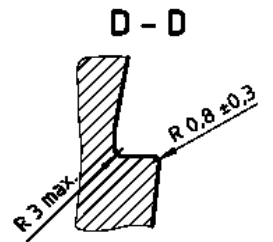
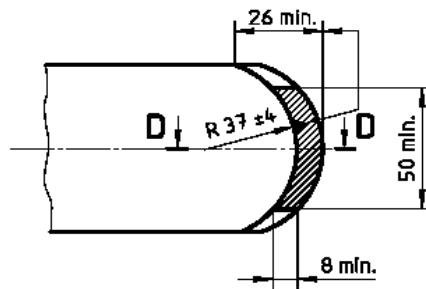
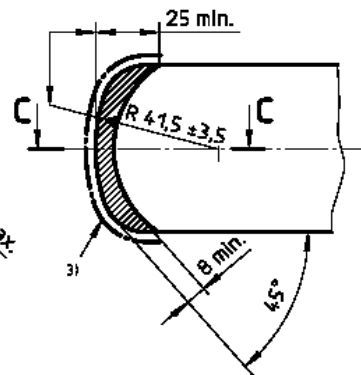
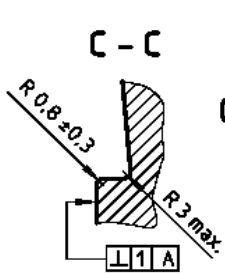
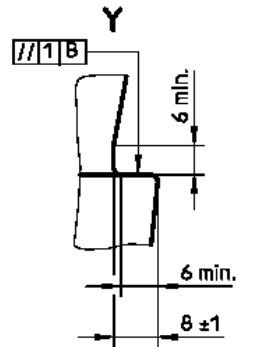
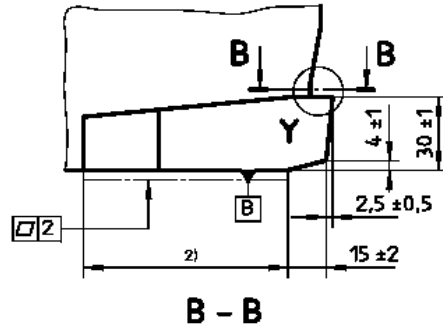
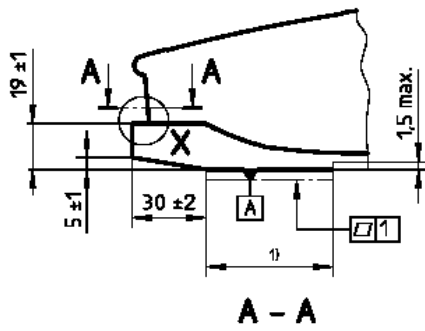
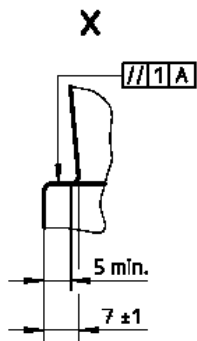
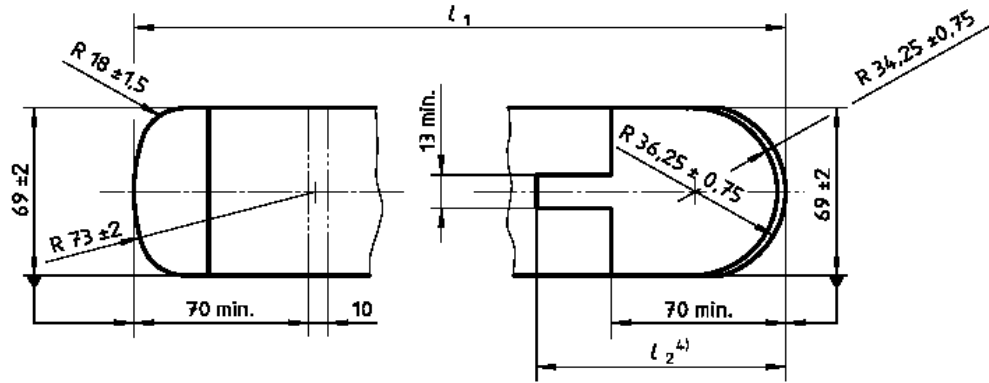

SCHEDULE B
Rossignol Ski Company, Incorporated (“Rossignol”)

ROSSIGNOL LIMITED PRODUCT WARRANTY -Race Stock Products

The Rossignol products provided under this Lease Agreement will be warranted by Rossignol to be free of defects in workmanship and materials for a period of two years from the date of delivery. If a product proves to be otherwise, Rossignol, in its sole discretion, will repair or replace the defective product at Rossignol’s expense. Rossignol will not be responsible for any costs associated with the loss of use of any product. This limited warranty is subject to the following limitations:

All products for which a warranty claim is being made must be returned to a Rossignol Service Center for inspection. All products are to be shipped prepaid and insured. Rossignol assumes no responsibility for products during shipment to a Service Center. Shipping costs are not refundable.

Repaired or replaced product will be returned in a reasonable amount of time. Return shipping costs will be borne by Rossignol.

This limited warranty does not apply to:

- a) Normal racing wear and tear.
- b) Impact related damage, such as rocks or trees.
- c) Racing gate impact/contact damage.
- d) High speed crash damage
- e) Damage resulting from faulty or improper mounting of bindings.
- f) Damage caused by the use of non-Rossignol hardware while mounting bindings.
- g) Damage from the use of solvents, adhesives or other substances not specifically determined for use on ski or snowboard products.
- h) Any damage caused from anything other than defects in material or workmanship.

Coverage under this limited warranty is void if any modifications or alterations have been made to the product not specifically authorized in writing by Rossignol. Repaired or replaced products are covered only for the remainder of the original warranty period.

All warranties implied by state law, including the implied warranties of merchantability and fitness for a particular purpose, are hereby limited to the duration of the written warranty. Some states do not allow limitations on how long an implied warranty lasts, so the above limitation may not apply. With the exception of any warranties implied by state law as hereby limited, the foregoing express limited warranty is exclusive and in lieu of all other warranties, guarantees, agreements and similar obligations of manufacturer or seller.